

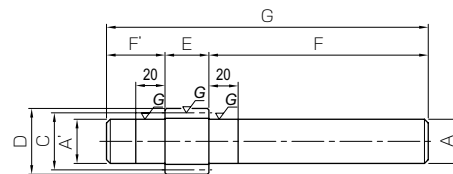

Specifications	
Precision grade	JIS grade N7 (JIS B1702-1: 1998) JIS grade 3 (JIS B1702: 1976)
Gear teeth	Standard full depth
Pressure angle	20°
Material	S45C
Heat treatment	Thermal refined, tooth surface induction hardened
Tooth hardness	45 ~ 55HRC



S7

Catalog No.	Pitch mm (Module)	No. of teeth	Profile shift coefficient	Shape	Shaft dia. (L)		Pitch dia. C	Outside dia.		Face width E	Shaft dia. (R)	
					A'	F'		D	A		F	
SSCPGS5-15	CP5 (1.5915)	15	0	S7	19.2	25	23.87	27.06	15	19.2	100	
SSCPGS5-20		20	0		27.2		31.83	35.01		27.2		
SSCPGS5-25		25	0		30.2		39.79	42.97		30.2		
SSCPGS10-10	CP10 (3.1831)	10	+0.5	S7	25.2	40	31.83	41.05	30	25.2	150	
SSCPGS10-15		15	0		35.2		47.75	54.11		35.2		
SSCPGS10-20		20	0		40.2		63.66	70.03		40.2		

[Caution on Product Characteristics]

- ① The allowable torques shown in the table are the calculated values according to the assumed usage conditions. Please see page 401 for more details.
- ② The backlash values shown in the table are the theoretical values when these gears and SRGCP Racks are in mesh.
- ③ To find the center distance of profile shifted spur gears, please see the appropriate section on page 51 - 52.



Specifications	
Precision grade	JIS grade N7 (JIS B1702-1: 1998) JIS grade 3 (JIS B1702: 1976)
Gear teeth	Standard full depth
Pressure angle	20°
Material	S45C
Heat treatment	Tooth surface induction hardened
Tooth hardness	45 ~ 55HRC

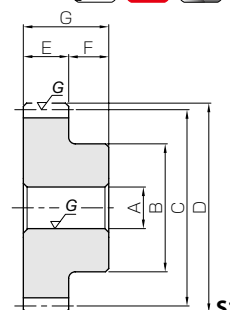

S1

Catalog No.	Pitch mm (Module)	No. of teeth	Shape	Bore	Hub dia.	Pitch dia.	Outside dia.	Face width	Hub width	Total length
				A _{H7}	B	C	D	E	F	G
SSCPG5-20	CP5 (1.5915)	20	S1	8	25	31.83	35.01	15	15	30
SSCPG5-25		25		10	32	39.79	42.97			
SSCPG5-30		30		10	38	47.75	50.93			
SSCPG5-40		40		12	50	63.66	66.85			
SSCPG10-20	CP10 (3.1831)	20	S1	15	50	63.66	70.03	30	20	50
SSCPG10-25		25		20	60	79.58	85.94			
SSCPG10-30		30		20	75	95.49	101.86			
SSCPG10-40		40		25	80	127.32	133.69			
SSCPG15-20	CP15 (4.7746)	20	S1	25	75	95.49	105.04	50	27	77
SSCPG15-25		25		25	100	119.37	128.92			
SSCPG15-30		30		25	110	143.24	152.79			
SSCPG20-20	CP20 (6.3662)	20	S1	25	100	127.32	140.06	60	30	90
SSCPG20-25		25		30	130	159.15	171.89			
SSCPG20-30		30		30	150	190.99	203.72			

[Caution on Product Characteristics]

- ① The allowable torques shown in the table are the calculated values according to the assumed usage conditions. Please see page 401 for more details.
- ② The backlash values shown in the table are the theoretical values when these gears and SRGCP Racks are in mesh.

Total length G	Distance traveled in one turn (mm)	Allowable torque (N·m)		Allowable torque (kgf·m)		Backlash (mm)	Weight (kg)	Catalog No.
		Bending strength	Surface durability	Bending strength	Surface durability			
140	75	21.2	8.49	2.16	0.87	0.04~0.18	0.34	SSCPGS5-15 SSCPGS5-20 SSCPGS5-25
	100	32.0	16.6	3.26	1.70	0.04~0.18	0.66	
	125	43.2	27.8	4.40	2.83	0.04~0.18	0.85	
220	100	121	25.9	12.4	2.64	0.05~0.20	0.97	SSCPGS10-10 SSCPGS10-15 SSCPGS10-20
	150	169	67.9	17.3	6.93	0.05~0.20	1.87	
	200	256	133	26.1	13.6	0.06~0.21	2.64	

- [Caution on Secondary Operations] ① Please read "Caution on Performing Secondary Operations" (Page 402) when performing modifications and/or secondary operations for safety concerns. Haguruma Kobo, the KHK's system for quick modification of KHK stock gears is also available.
- ② Due to the gear teeth being induction hardened, no secondary operations can be performed on tooth areas including the bottom land (approx. 1 to 2 mm). Use carbide tools for the modification of the shaft area near the bottom land.

SSCPG

CP Ground Spur Gears

Distance traveled in one turn (mm)	Allowable torque (N·m)		Allowable torque (kgf·m)		Backlash (mm)	Weight (kg)	Catalog No.
	Bending strength	Surface durability	Bending strength	Surface durability			
100	24.8	13.7	2.53	1.40	0.04~0.18	0.14	SSCPG5-20 SSCPG5-25 SSCPG5-30 SSCPG5-40
125	33.5	23.0	3.41	2.34	0.04~0.18	0.22	
150	42.3	35.0	4.32	3.57	0.04~0.18	0.33	
200	60.4	66.9	6.16	6.82	0.05~0.19	0.58	
200	198	110	20.2	11.2	0.06~0.21	0.99	SSCPG10-20 SSCPG10-25 SSCPG10-30 SSCPG10-40
250	268	184	27.3	18.7	0.06~0.21	1.49	
300	339	280	34.5	28.5	0.06~0.21	2.26	
400	483	535	49.3	54.6	0.07~0.22	3.59	
300	744	399	75.9	40.7	0.07~0.23	3.45	SSCPG15-20 SSCPG15-25 SSCPG15-30
375	1005	667	102	68.0	0.09~0.25	5.76	
450	1270	1020	130	104	0.09~0.25	8.04	
400	1590	880	162	89.7	0.09~0.25	7.50	SSCPG20-20 SSCPG20-25 SSCPG20-30
500	2140	1470	219	150	0.09~0.25	12.0	
600	2710	2240	276	228	0.09~0.25	17.2	

- [Caution on Secondary Operations] ① Please read "Caution on Performing Secondary Operations" (Page 402) when performing modifications and/or secondary operations for safety concerns. Haguruma Kobo, the KHK's system for quick modification of KHK stock gears is also available.
- ② Due to the gear teeth being induction hardened, no secondary operations can be performed on tooth areas including the bottom land (approx. 1 to 2 mm).