



Newly added



Specifications	
Precision grade	JIS grade N8 (JIS B1702-1: 1998) * JIS grade 4 (JIS B1702: 1976)
Gear teeth	Standard full depth
Pressure angle	20°
Material	S45C
Heat treatment	—
Tooth hardness	less than 194HB

* The precision grade of products with a module of less than 0.8 is equivalent to the value shown in the table.

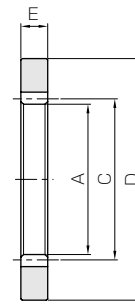

T1

Catalog No. <small>New items indicated in blue letters.</small>	Module	No. of teeth	Shape	Internal dia.				Allowable torque (N·m)		Allowable torque (kgf·m)		Backlash (mm)	Weight (kg)
				A	C	D	E	Bending strength	Surface durability	Bending strength	Surface durability		
S10.5-60 S10.5-80 S10.5-100	m0.5	60	T1	29	30	50	5	3.75	0.67	0.38	0.07	0.04~0.15	0.049
80		T1	39	40	60	5	4.85	0.75	0.49	0.08	0.04~0.15	0.062	
100		T1	49	50	70	5	5.97	0.87	0.61	0.09	0.04~0.15	0.074	
S10.8-60 S10.8-80 S10.8-100	m0.8	60	T1	46.4	48	75	8	15.4	2.87	1.57	0.29	0.05~0.16	0.16
80		T1	62.4	64	90	8	19.9	3.24	2.03	0.33	0.05~0.16	0.20	
100		T1	78.4	80	105	8	24.5	3.75	2.50	0.38	0.05~0.16	0.23	
S11-60 S11-80 S11-100	m1	60	T1	58	60	90	10	30.0	5.95	3.06	0.61	0.10~0.22	0.28
80		T1	78	80	110	10	38.8	6.59	3.96	0.67	0.10~0.22	0.35	
100		T1	98	100	130	10	47.8	7.64	4.87	0.78	0.12~0.25	0.43	
S11.5-50 S11.5-60 S11.5-80 S11.5-100	m1.5	50	T1	72	75	115	15	87.1	20.9	8.88	2.13	0.13~0.29	0.70
60		T1	87	90	130	15	101	20.6	10.3	2.10	0.13~0.29	0.81	
80		T1	117	120	160	15	131	23.3	13.4	2.38	0.13~0.29	1.04	
100		T1	147	150	190	15	161	27.0	16.5	2.75	0.15~0.32	1.26	
S12-50 S12-60 S12-80 S12-100	m2	50	T1	96	100	150	20	206	50.3	21.0	5.13	0.16~0.33	1.54
60		T1	116	120	170	20	240	50.5	24.5	5.15	0.16~0.33	1.79	
80		T1	156	160	210	20	311	57.0	31.7	5.81	0.16~0.33	2.28	
100		T1	196	200	250	20	382	65.7	39.0	6.70	0.17~0.37	2.77	
S12.5-50 S12.5-60 S12.5-80	m2.5	50	T1	120	125	185	25	403	101	41.1	10.3	0.17~0.37	2.87
60		T1	145	150	210	25	469	101	47.8	10.3	0.17~0.37	3.33	
80		T1	195	200	260	25	607	114	61.9	11.6	0.17~0.37	4.25	
S13-50 S13-60	m3	50	T1	144	150	220	30	697	178	71.0	18.1	0.19~0.41	4.79
60		T1	174	180	250	30	811	178	82.7	18.2	0.19~0.41	5.57	

[Caution on Product Characteristics]

- ① The backlash values shown in the table are the theoretical values for the normal direction for the internal ring in mesh with a 30 tooth SS spur gear.
- ② The allowable torque shown in the table are the calculated values according to the assumed usage conditions. Please see page 366 for more details
- ③ Please check for the involute interference, trochoid interference and trimming interference prior to using internal gears.

[Caution on Secondary Operations]

- ① Please read "Caution on Performing Secondary Operations" (Page 36) when performing modifications and/or secondary operations for safety concerns. Haguruma Kobo, the KHK's system for quick modification of KHK stock gears is also available.
- ② Avoid performing secondary operations that narrow the tooth width as it affects precision and strength.