



Specifications	
Precision grade	KHK R 001 grade 1
Reference section of gear	Rotating plane
Gear teeth	Standard full depth
Transverse pressure angle	20°
Helix angle	21°30'
Material	SCM440
Heat treatment	Thermal refining only
Tooth hardness	250 ~ 285HB

Catalog No.	Module	Effective no. of teeth	Direction of helix	Shape	Total length		Face width	Height	Height to pitch line	Allowable force (N)		Allowable force (kgf)	
					A	B				C	D	Bending strength	Surface durability
KRHG1-100R KRHG1-100L	m1	28	R L	RR RL	98	8	15	14	1290	955	131	97.4	
KRHG1.5-100R KRHG1.5-100L	m1.5	19	R L	RR RL	101	12	20	18.5	2890	2380	295	243	
KRHG2-100R KRHG2-100L	m2	13	R L	RR RL	98	16	25	23	5140	4230	524	432	
KRHG2.5-100R KRHG2.5-100L	m2.5	10	R L	RR RL	100	20	30	27.5	8030	6610	819	674	
KRHG3-100R KRHG3-100L	m3	8	R L	RR RL	102	25	35	32	12000	9810	1230	1000	

Catalog No.	Module	No. of teeth	Direction of helix	Shape	Total length		Face width	Height	Height to pitch line	Allowable force (N)	
					A	A'				B	C
KRHGF1-500R KRHGF1-500L	m1	159	R L	RFR RFL	499.51	502.66	8	15	14	1290	955
KRHGF1.5-500R KRHGF1.5-500L	m1.5	106	R L	RFR RFL	499.51	504.23	12	20	18.5	2890	2380
KRHGF2-1000R KRHGF2-1000L	m2	160	R L	RFR RFL	1005.31	1011.61	16	25	23	5140	4230
KRHGF2.5-1000R KRHGF2.5-1000L	m2.5	128	R L	RFR RFL	1005.31	1013.19	20	30	27.5	8030	6610
KRHGF3-1000R KRHGF3-1000L	m3	106	R L	RFR RFL	999.03	1008.88	25	35	32	12000	9810

[Caution on Product Characteristics]

- ① The allowable forces shown in the table are the calculated values according to the assumed usage conditions. Please see page 373 for more details.
- ② The backlash of racks differ depending on the size of the mating pinion. Please calculate the backlash from the backlash value of the mating pinion. Also, please refer to the data in the section called 'Backlash of Rack Tooth (Amount of Tooth Thinning)' on Page 375.
- ③ Please use KHG Ground Helical Gears as the mating pinion.
- ④ These racks produce axial thrust forces. See page 351 for more details.

Ground Helical Racks

Weight (kg)	Catalog No.
0.086	KRHG1-100R KRHG1-100L
0.18	KRHG1.5-100R KRHG1.5-100L
0.28	KRHG2-100R KRHG2-100L
0.43	KRHG2.5-100R KRHG2.5-100L
0.64	KRHG3-100R KRHG3-100L

Allowable force (kgf)		Weight (kg)	Catalog No.
Bending strength	Surface durability		
131	97.4	0.44	KRHGF1-500R KRHGF1-500L
295	243	0.87	KRHGF1.5-500R KRHGF1.5-500L
524	432	2.90	KRHGF2-1000R KRHGF2-1000L
819	674	4.34	KRHGF2.5-1000R KRHGF2.5-1000L
1230	1000	6.27	KRHGF3-1000R KRHGF3-1000L

[Caution on Secondary Operations] ① Please read "Caution on Performing Secondary Operations" (Page 376) when performing modifications and/or secondary operations for safety concerns. Haguruma Kobo, the KHK's system for quick modification of KHK stock gears is also available.

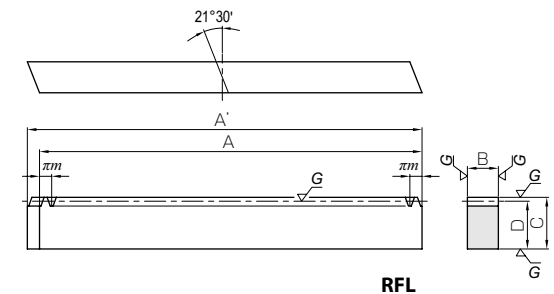
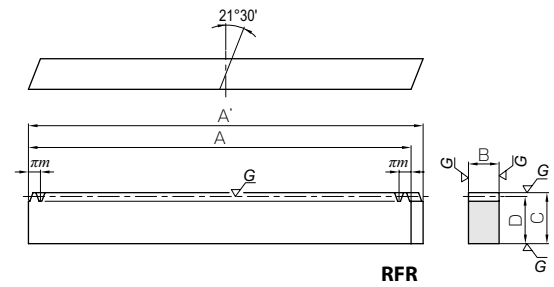
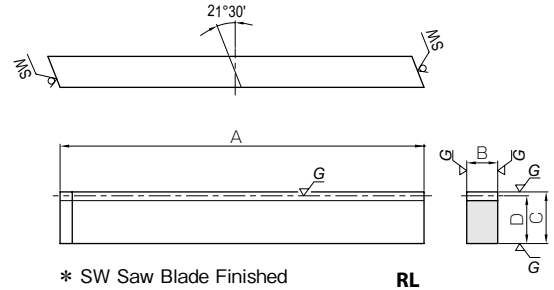
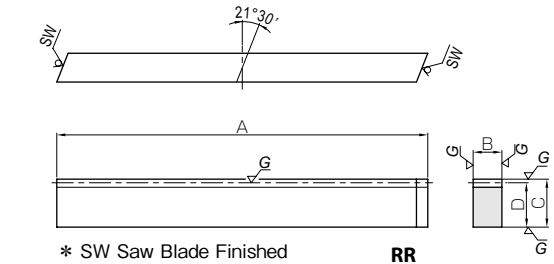

Spur Gears

Helical Gears

Internal Gears

Racks

CP Racks & Pinions

Miter Gears

Bevel Gears

Screw Gears

Worm Gear Pair

Bevel Gearboxes

Other Products