

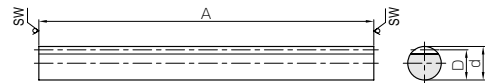

Specifications	
Precision grade	KHK R 001 grade 4
Gear teeth	Standard full depth
Pressure angle	20°
Material	S45C
Heat treatment	Stress relief annealing
Tooth hardness	less than 95HRB

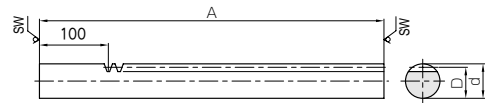

R2



R7

* SW Saw Blade Finished

Catalog No.	Module	Effective no. of teeth	Shape	Total length	Outside dia.	Height to pitch line	Allowable force (N)		Allowable force (kgf)		Weight (kg)
				A	d_{h9}	D	Bending strength	Surface durability	Bending strength	Surface durability	
SRO1-500	m1	159	R2	505	10	9	800	121	81.6	12.3	0.29
SRO1.5-500	m1.5	105	R2	505	15	13.5	1800	288	184	29.3	0.65
SRO2-500	m2	79	R2	505	20	18	3200	530	326	54.0	1.16
SRO2-1000		159		1010							
SRO2.5-500	m2.5	63	R2	505	25	22.5	5000	848	510	86.5	1.81
SRO2.5-1000		127		1010							
SRO3-500	m3	52	R2	505	30	27	7200	1240	735	127	2.60
SRO3-1000		105		1010							
SRO4-500	m4	39	R2	505	40	36	12800	2270	1310	232	4.62
SRO4-1000		79		1010							
SRO5-1000	m5	63	R2	1010	50	45	20000	3620	2040	369	14.4
SRO6-1000	m6	52	R2	1010	60	54	28800	5290	2940	539	20.8

Catalog No.	Module	Effective no. of teeth	Shape	Total length	Outside dia.	Height to pitch line	Allowable force (N)		Allowable force (kgf)		Weight (kg)
				A	d_{h9}	D	Bending strength	Surface durability	Bending strength	Surface durability	
SROS1-500	m1	128	R7	505	10	9	800	121	81.6	12.3	0.29
SROS1.5-500	m1.5	85	R7	505	15	13.5	1800	288	184	29.3	0.66
SROS2-500	m2	64	R7	505	20	18	3200	530	326	54.0	1.17
SROS2.5-500	m2.5	51	R7	505	25	22.5	5000	848	510	86.5	1.83
SROS3-500	m3	42	R7	505	30	27	7200	1240	735	127	2.64

[Caution on Product Characteristics]

- ① The allowable forces shown in the table are the calculated values according to the assumed usage conditions. Please see page 373 for more details.
- ② The backlash of racks differ depending on the size of the mating pinion. Please calculate the backlash from the backlash value of the mating pinion. Also, please refer to the data in the section called 'Backlash of Rack Tooth (Amount of Tooth Thinning)' on Page 375.
- ③ Tolerance of "d" dimension of SRO6-1000 is h10.

[Caution on Secondary Operations]

- ① Please read "Caution on Performing Secondary Operations" (Page 376) when performing modifications and/or secondary operations for safety concerns. Haguruma Kobo, the KHK's system for quick modification of KHK stock gears is also available.
- ② Please avoid hardening of Round Racks. It causes contortion and deformation, and straightening processes can hardly be applied.

Spur Gears
Helical Gears
Internal Gears
Racks
CP Racks & Pinions
Miter Gears
Bevel Gears
Screw Gears
Worm Gear Pair
Bevel Gearboxes
Other Products