

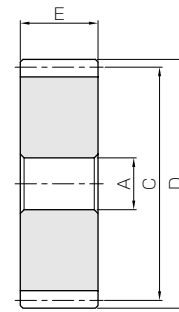

Specifications	
Precision grade	JIS grade N8 (JIS B1702-1: 1998) JIS grade 4 (JIS B1702: 1976)
Gear teeth	Standard full depth
Pressure angle	20°
Material	S45C
Heat treatment	—
Tooth hardness	less than 194HB



S5

Catalog No.	Module	No. of teeth	Shape	Bore	Pitch dia.	Outside dia.	Face width	Allowable torque (N·m)		Allowable torque (kgf·m)	
				A <sub>H7</sub>	C	D	E	Bending strength	Surface durability	Bending strength	Surface durability
<b>SSAY1-20</b>	<b>m1</b>	20	S5	6	20	22	6	3.45	0.20	0.35	0.021
<b>SSAY1-24</b>		24	S5	6	24	26	6	4.48	0.30	0.46	0.030
<b>SSAY1-25</b>		25	S5	6	25	27	6	4.74	0.32	0.48	0.033
<b>SSAY1-28</b>		28	S5	6	28	30	6	5.55	0.41	0.57	0.042
<b>SSAY1-30</b>		30	S5	6	30	32	6	6.08	0.47	0.62	0.048
<b>SSAY1-32</b>		32	S5	6	32	34	6	6.63	0.54	0.68	0.055
<b>SSAY1-35</b>		35	S5	6	35	37	6	7.45	0.66	0.76	0.067
<b>SSAY1-36</b>		36	S5	6	36	38	6	7.73	0.70	0.79	0.071
<b>SSAY1-40</b>		40	S5	6	40	42	6	8.84	0.87	0.90	0.089
<b>SSAY1-45</b>		45	S5	6	45	47	6	10.3	1.12	1.05	0.11
<b>SSAY1-48</b>		48	S5	6	48	50	6	11.1	1.28	1.13	0.13
<b>SSAY1-50</b>		50	S5	8	50	52	6	11.7	1.39	1.19	0.14
<b>SSAY1-55</b>		55	S5	8	55	57	6	13.1	1.70	1.34	0.17
<b>SSAY1-56</b>		56	S5	8	56	58	6	13.4	1.77	1.37	0.18
<b>SSAY1-60</b>		60	S5	8	60	62	6	14.5	2.04	1.48	0.21
<b>SSAY1-70</b>		70	S5	8	70	72	6	17.4	2.82	1.78	0.29
<b>SSAY1-80</b>		80	S5	10	80	82	6	20.3	3.74	2.07	0.38
<b>SSAY1-100</b>		100	S5	10	100	102	6	26.2	5.98	2.67	0.61

[Caution on Product Characteristics]

- ① The allowable torques shown in the table are calculated values according to the assumed usage conditions. Please see page 35 for more details.
- ② The backlash values shown in the table are the theoretical values for the backlash in the normal direction of a pair of identical gears in mesh.

- Spur Gears
- Helical Gears
- Internal Gears
- Racks
- CP Racks & Pinions
- Miter Gears
- Bevel Gears
- Screw Gears
- Worm Gear Pair
- Bevel Gearboxes
- Other Products

## Steel Hubless Thin Face Spur Gears

Backlash (mm)	Weight (kg)	Catalog No.
0.08~0.18	0.013	<b>SSAY1-20</b>
	0.020	<b>SSAY1-24</b>
	0.022	<b>SSAY1-25</b>
	0.028	<b>SSAY1-28</b>
	0.032	<b>SSAY1-30</b>
0.08~0.18	0.037	<b>SSAY1-32</b>
	0.044	<b>SSAY1-35</b>
	0.047	<b>SSAY1-36</b>
	0.058	<b>SSAY1-40</b>
	0.074	<b>SSAY1-45</b>
0.08~0.18	0.084	<b>SSAY1-48</b>
	0.090	<b>SSAY1-50</b>
	0.11	<b>SSAY1-55</b>
	0.11	<b>SSAY1-56</b>
	0.13	<b>SSAY1-60</b>
0.08~0.18	0.18	<b>SSAY1-70</b>
	0.23	<b>SSAY1-80</b>
	0.37	<b>SSAY1-100</b>

- [Caution on Secondary Operations]
- ① Please read "Caution on Performing Secondary Operations" (Page 36) when performing modifications and/or secondary operations for safety concerns. Haguruma Kobo, the KHK's system for quick modification of KHK stock gears is also available.
  - ② When performing secondary operations, be aware of deflection and distortion as the tooth is thin in width; deflection might occur if heat treated.
  - ③ Avoid performing secondary operations that narrow the tooth width as it affects precision and strength.

Spur  
GearsHelical  
GearsInternal  
Gears

Racks

CP Racks  
& PinionsMiter  
GearsBevel  
GearsScrew  
GearsWorm  
Gear PairBevel  
GearboxesOther  
Products