



**source
manufacturer**



**one-stop
shopping**



**Non-standard
customization**



**Automation
Solutions**



**Modular
Products**

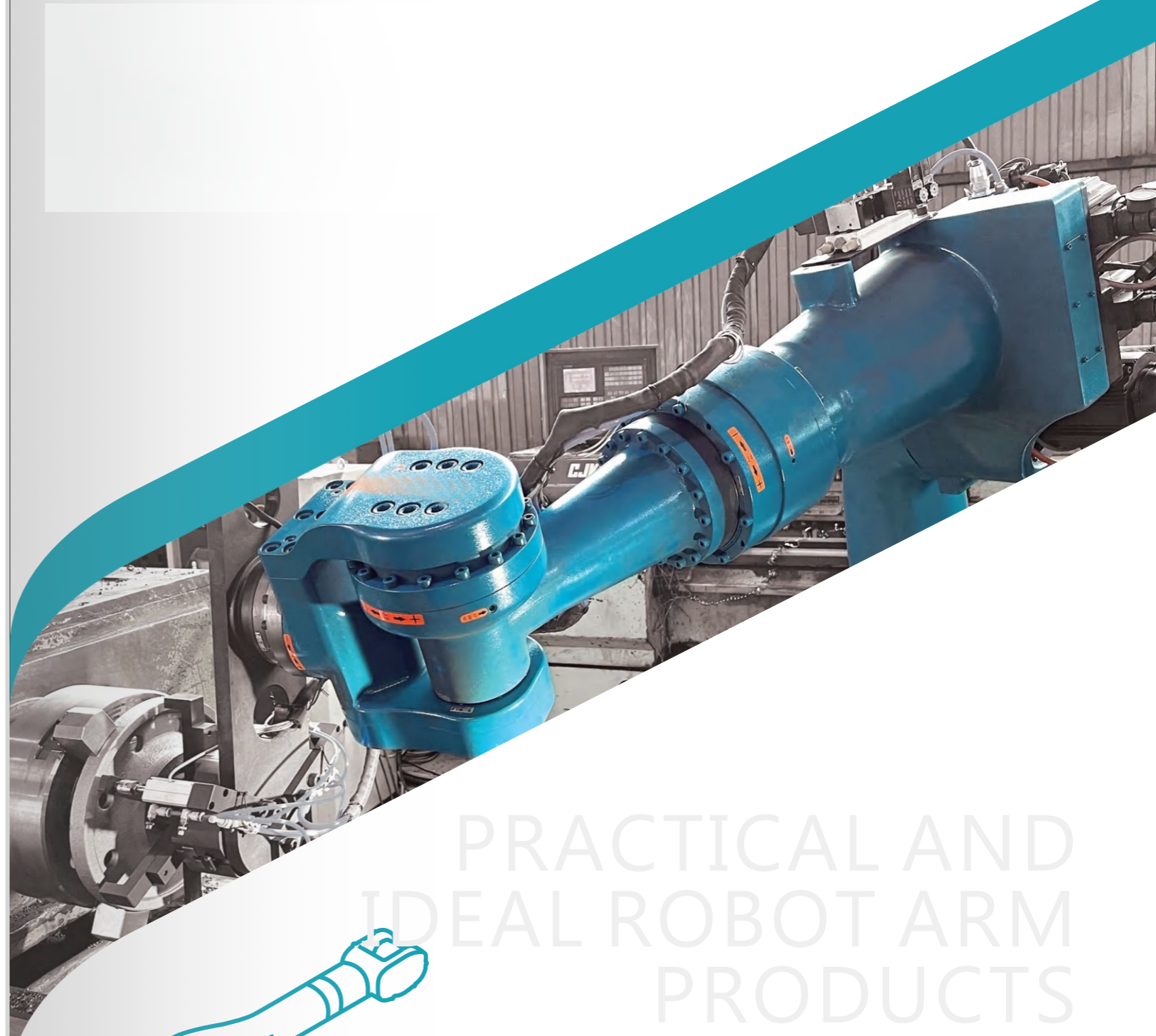

PRACTICAL AND
IDEAL ROBOT ARM
PRODUCTS

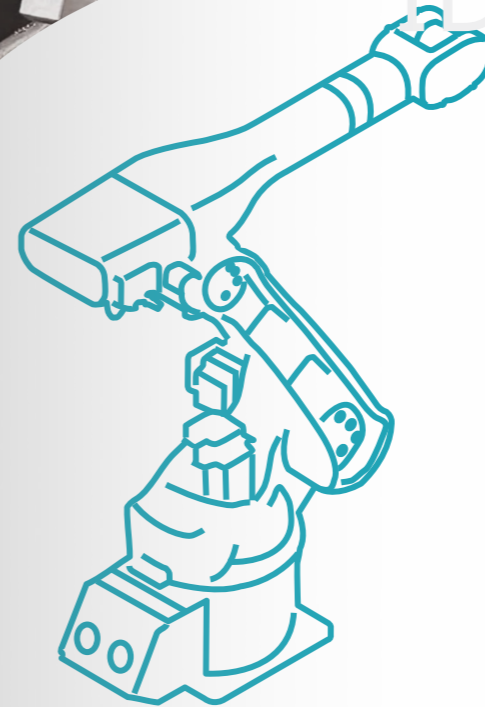

NAMING RULES

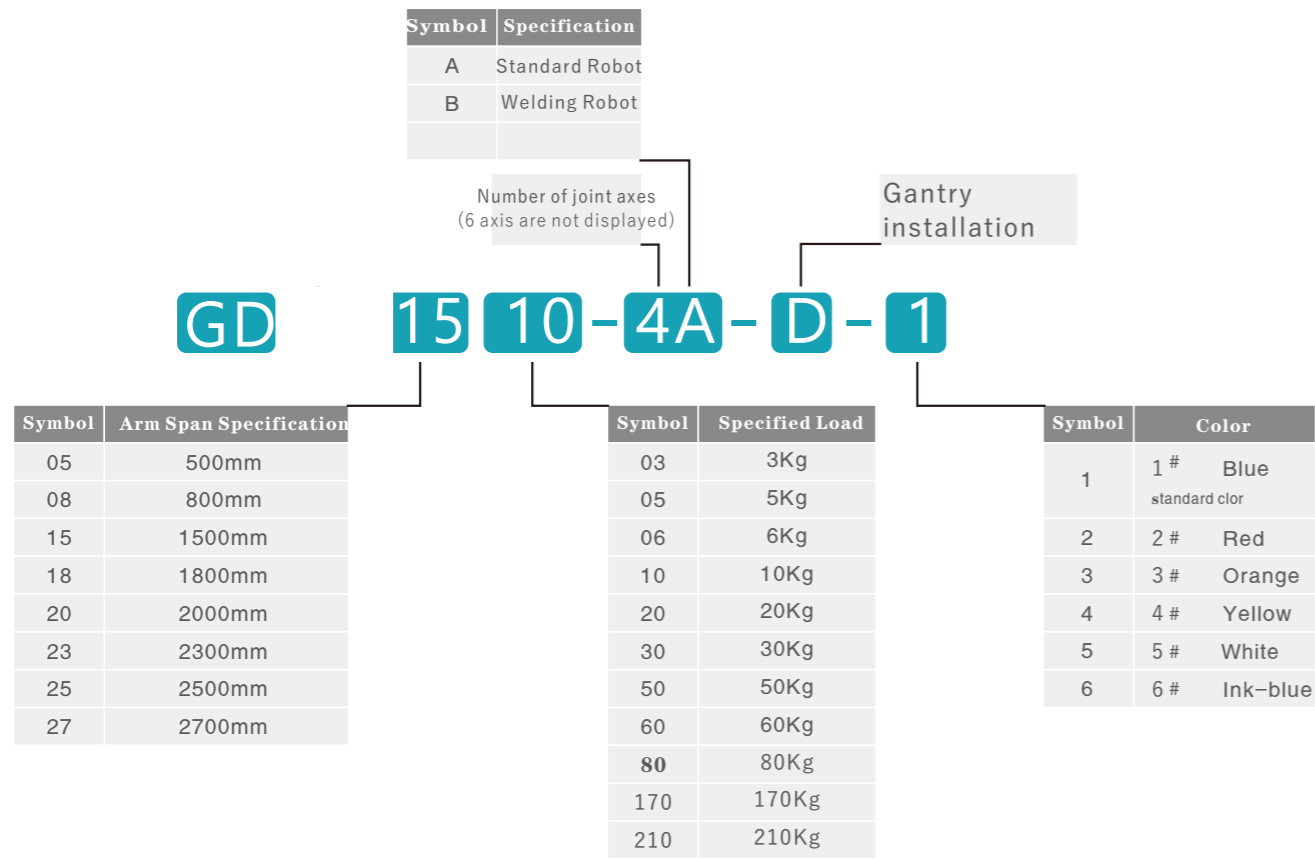

eg :

GD1806A-D

- Handling Robot
- Arm Span 1800mm
- Specified Load 6Kg
- Can be installed upside down
- Blue

GD1510A

- Handling Robot
- Arm Span 1500mm
- Specified Load 10Kg
- Blue

GD1506B

- Welding Robot
- Arm Span 1500mm
- Specified Load 6Kg
- Blue

GD1510-4A-2

- Handling Robot
- Arm Span 1500mm
- Specified Load 10Kg
- 4 Axis
- Red



Industrial robot body Electric control cabinet

Industrial Robot Body Optional Color



NEW SERIES STANDARD ROBOT

3-210KG load 10 models



GD60407
Specified Load 4Kg
Maximum Arm Span 700mm



GD0805A
Specified Load 5Kg
Maximum Arm Span 800mm



GD1806A
Specified Load 6Kg
Maximum Arm Span 1800mm



GD1510A
Specified Load 10Kg
Maximum Arm Span 1497.8mm



GD2010A
Specified Load 10Kg
Maximum Arm Span 2000mm



GD40814
Specified Load 8Kg
Maximum Arm Span 1400mm



GD42017
Specified Load 20kg
Maximum Arm Span 1770mm



GD2560A
Specified Load 60Kg
Maximum Arm Span 2499mm



GD2380A
Specified Load 80Kg
Maximum Arm Span 2302mm



GD27180A
Specified Load 180Kg
Maximum Arm Span 2720mm



GD25210A
Specified Load 210Kg
Maximum Arm Span 2523mm

NEW SERIES HANDLING ROBOT



Technical Parameter

	60407	0805A	1806A	1510A	2010A	40814	42017	2560A	2380A	27180A	25210A	
Basic Parameters	Degrees of Freedom	6	6	6	6	6	6	6	6	6	6	
	Specified Load	4 Kg	5 Kg	6 Kg	10 Kg	10 Kg	8 Kg	20 Kg	60 Kg	80 Kg	180 Kg	210 Kg
	J3Additional Load		5 Kg	12 Kg	12 Kg	12 Kg			30 Kg	30 Kg	30 Kg	30 Kg
	Repeatability	± 0.1 mm	± 0.05mm	± 0.05mm	± 0.05mm	± 0.05mm	± 0.08mm	± 0.08mm	± 0.15mm	± 0.15mm	± 0.15mm	± 0.15mm
	Body Mass		56 Kg	164 Kg	160 Kg	230 Kg			560 Kg	550 Kg	1035 Kg	1025 Kg
	Installation Method	ground	ground/wall	ground/wall	ground/wall	ground/wall	ground	ground	ground/wall	ground/wall	ground	ground
	Battery Capacity	2.0 KW	1.1 KW	2.5KW	2.5 KW	2.5 KW	2.5 KW	3.8 KW	9.0KW	9.0 KW	14KW	14KW
	Voltage	220V	220V	380V	380V	380V	380V	380V	380V	380V	380V	380V
	Brake		J2、3、5 with brake	all with brake	all with brake	all with brake			all with brake	all with brake	all with brake	all with brake
Range of Motion	Maximum Reach at P		800 mm	1800 mm	1497.8 mm	2000 mm			2499mm	2302 mm	2720mm	2523mm
	Minimum Reach at P		190 mm	437 mm	419.9 mm	457 mm			710 mm	603 mm	738 mm	549 mm
	J1	± 165°	± 170°	± 170°	± 170°	± 170°	± 170°	± 170°	± 170°	± 170°	± 180°	± 180°
	J2	-100° ~ +120°	-90° ~ +90°	-160° ~ +80°	-160° ~ +80°	-160° ~ +80°	-38° ~ +78°	-40° ~ +85°	-165° ~ +90°	-165° ~ +90°	-93° ~ +60°	-93° ~ +60°
	J3	-60° ~ +150°	-90° ~ +90°	-85° ~ +90°	-85° ~ +90°	-85° ~ +90°	-90° ~ +10°	-90° ~ +20°	-85° ~ +145°	-84° ~ +145°	-80° ~ +110°	-80° ~ +110°
	J4	± 175°	± 170°	± 360°	± 360°	± 360°	± 360°	± 360°	± 360°	± 360°	± 360°	± 360°
	J5	-30° ~ +130°	± 120°	± 120°	± 120°	± 120°			± 125°	± 125°	± 120°	± 120°
Maxmum Speed	J1	260° /s	220° /s	138° /s	148° /s	104° /s	150° /s	150° /s	83° /s	83° /s	60° /s	60° /s
	J2	250° /s	220° /s	138° /s	148° /s	74° /s	149° /s	149° /s	83° /s	83° /s	63° /s	63° /s
	J3	250° /s	220° /s	223° /s	173° /s	223° /s	225° /s	150° /s	104° /s	104° /s	63° /s	63° /s
	J4	250° /s	290° /s	168° /s	168° /s	270° /s	375° /s	297.5° /s	212° /s	212° /s	136° /s	136° /s
	J5	200° /s	337° /s	270° /s	270° /s	337° /s			173° /s	173° /s	148° /s	148° /s
	J6	600° /s	540° /s	337° /s	337° /s	540° /s			259° /s	259° /s	200° /s	200° /s
	Speed	1.5 m/s	1.5 m/s	1.5 m/s	1.5 m/s	1.5 m/s			1.0 m/s	1.0 m/s	1.0 m/s	1.0 m/s
Allowable Moment	J4		15.0 N·m	15.0 N·m	20.0 N·m	15.0 N·m			366.0 N·m	366.0 N·m	980.0 N·m	980.0 N·m
	J5		15.0 N·m	15.0 N·m	20.0 N·m	15.0 N·m			307.0 N·m	307.0 N·m	784.0 N·m	784.0 N·m
	J6		5.0 N·m	5.0 N·m	16.0 N·m	5.0 N·m			167.0 N·m	167.0 N·m	412.0 N·m	412.0 N·m
Other	End Flange		solid	solid	solid	solid			solid	solid	solid	solid
	Change to 5 Axis		✓	✓	✓	✓			✓	✓	✓	✓
	Custom Gantry		✓	✓	✓	✓			✓	✓	✓	✓
	Isolation Transformer		×	✓	✓	✓			×	×	×	×
	Main Purpose	palletizing/welding/ painting	handling/load and unload/ teaching/play chess	handling/palletizing/load and unload/ gluing/painting	handling/palletizing/load and unload/ gluing/painting	handling/palletizing/load and unload/ gluing/painting	palletizing/carrying/ discharge	palletizing/carrying/ discharge	handling/palletizing/ load and unload	handling/palletizing/ load and unload	handling/palletizing/ load and unload/spot welding	handling/palletizing/ load and unload/spot welding

GD60407 HANDLING ROBOT



4KG
Load

700mm
Arm Span

TECHNICAL PARAMETERS				
Basic Parameters	Degrees of Freedom	6	Installation Method	ground
	Specified Load	4kg	Battery Capacity	2.0 KW
	Usage environment	0-50℃, 20-80%RH	Voltage	220V
	Body Mass	25kg	Brake	J2, 3 with brake
	Repeatability	±0.1mm		
Range of Motion	J1	±165°	J4	±175°
	J2	-100° ~+120°	J5	-30° ~+130°
	J3	-60° ~+150°	J6	±180°
	Speed			
Maximum Speed	J1	260° /s	J4	250° /s
	J2	250° /s	J5	200° /s
	J3	250° /s	J6	600° /s
	Speed			
1.5m/s				
Protection Grade	body IP53, wrist Ip54			
Main Purpose	welding/discharging/painting and etc.			

INSTALLATION DIMENSIONS

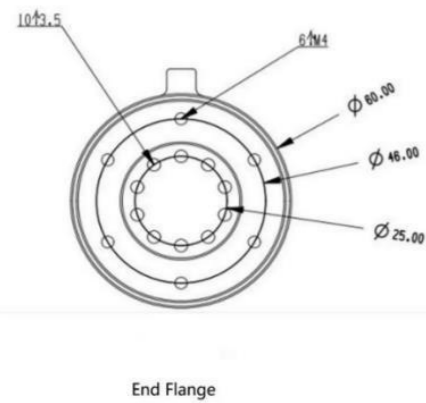
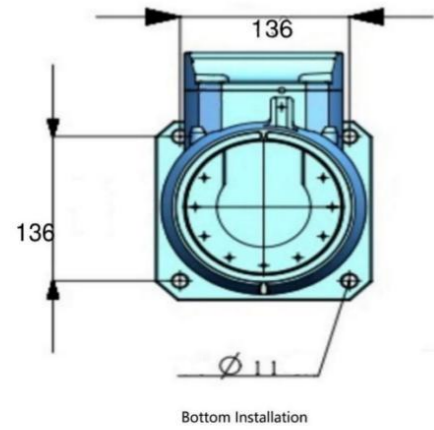

ACTUATION RANGE

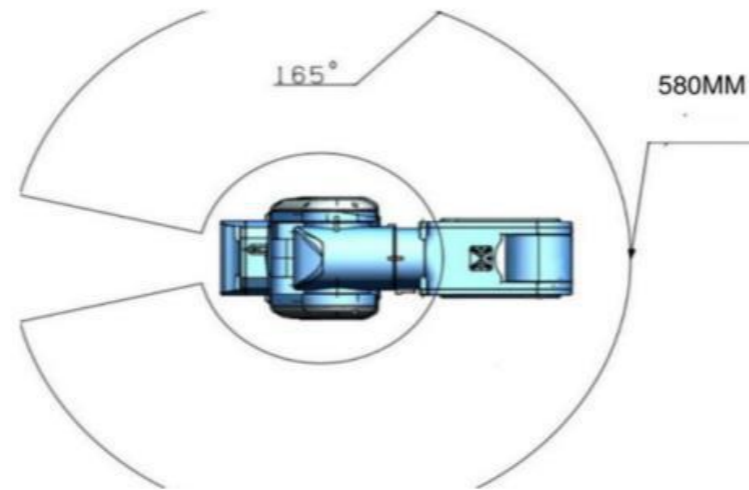

GD0805A HANDLING ROBOT



5KG
Load

800mm
Arm Span

TECHNICAL PARAMETERS				
Basic Parameters	Degrees of Freedom	6	Installation Method	ground/side wall
	Specified Load	5kg	Battery Capacity	1.1 KW
	J3 Additional Load	5kg	Voltage	220V
	Body Mass	56kg	Brake	J2, 3, 5 with brake
	Repeatability	±0.05mm		
Range of Motion	Maximum Reach at P	800 mm	J3	-90° ~+90°
	Minimum Reach at P	190 mm	J4	±170°
	J1	±170°	J5	±120°
	J2	-90° ~+90°	J6	±360°
Maximum Speed	J1	220° /s	J4	290° /s
	J2	220° /s	J5	337° /s
	J3	220° /s	J6	540° /s
	Speed			
1.5m/s				
allowable moment End Flange	J4 15.0 N·m	J5 15.0 N·m	J6 5.0 N·m	
change to 5 axis	solid	Custom Gantry Mount	✓	Main Purpose handling/load and unload/teaching/play chess
	Isolation Transformer	×		

INSTALLATION DIMENSIONS

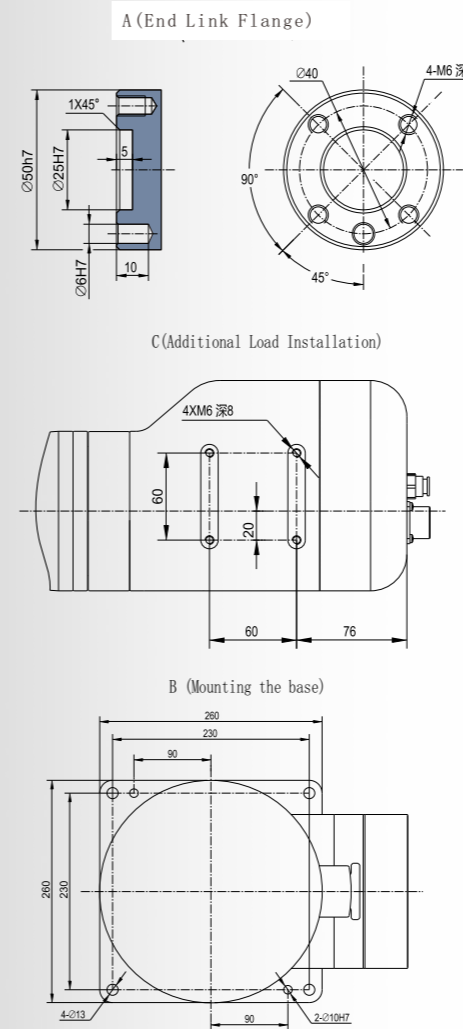

ACTUATION RANGE

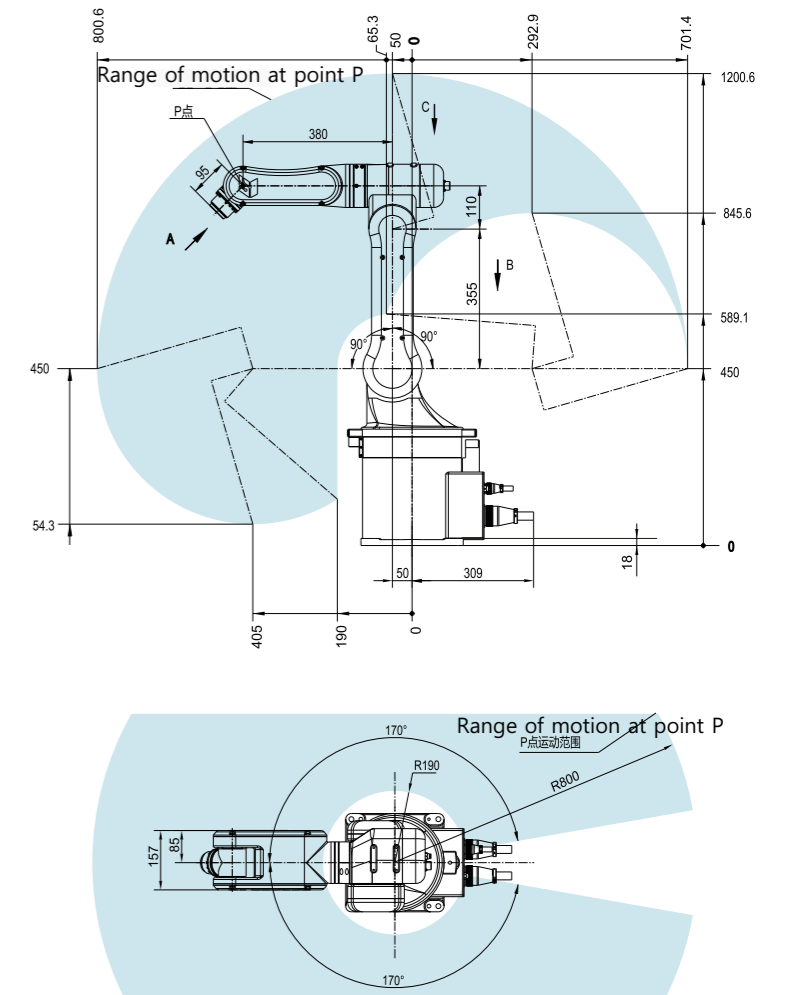

GD1806A

HANLING ROBOT



6KG
Load

1800mm
Arm Span

TECHNICAL PARAMETERS

Basic Parameters	Degrees of Freedom	6		Installation Method	ground/side wall	
	Specified Load	6kg		Battery Capacity	2.5 KW	
	J3 Additional Load	12kg		Voltage	380V	
	Body Mass	164kg		Brake	all with brake	
	Repeatability	± 0.05mm				
Range of Motion	Maximum Reach at P	1800mm		J3	-85° ~+90°	
	Minimum Reach at P	437 mm		J4	± 360°	
	J1	± 170°		J5	± 120°	
	J2	-160° ~+80°		J6	± 360°	
Maximum Speed	J1	138° /s		J4	168° /s	
	J2	138° /s		J5	270° /s	
	J3	223° /s		J6	337° /s	
	Speed	1.5m/s				
allowable moment	J4	15.0 N·m	J5	15.0 N·m	J6	5.0 N·m
End Flange	solid	Custom Gantry Mount	✓	Main Purpose	handling/palletizing/load and unload/painting	
change to 5 axis	✓	Isolation Transformer	✓			

INSTALLATION DIMENSIONS

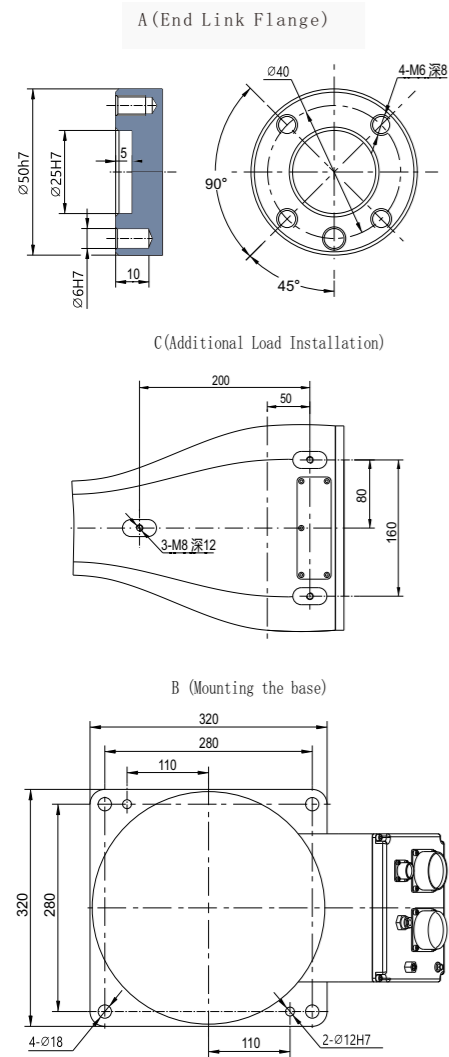

ACTUATION RANGE

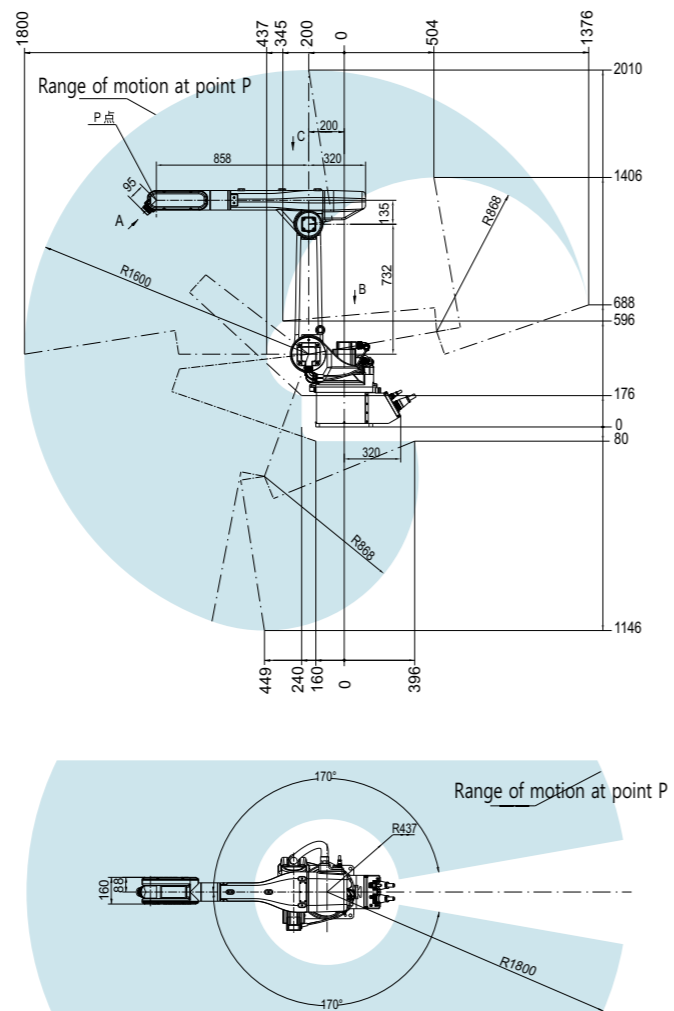

GD1510A

HANLING ROBOT

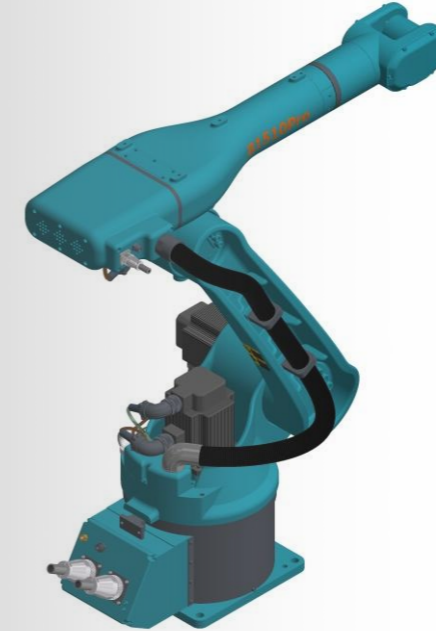

10KG
Load

1497.8mm
Arm Span

TECHNICAL PARAMETERS

Basic Parameters	Degrees of Freedom	6		Installation Method	ground/side wall	
	Specified Load	10kg		Battery Capacity	2.5 KW	
	J3 Additional Load	12kg		Voltage	380V	
	Body Mass	160kg		Brake	all with brake	
	Repeatability	± 0.05mm				
Range of Motion	Maximum Reach at P	1497.8mm		J3	-85° ~+90°	
	Minimum Reach at P	419.9mm		J4	± 360°	
	J1	± 170°		J5	± 120°	
	J2	-160° ~+80°		J6	± 360°	
Maximum Speed	J1	148° /s		J4	168° /s	
	J2	148° /s		J5	270° /s	
	J3	173° /s		J6	337° /s	
	Speed	1.5m/s				
allowable moment	J4	20.0 N·m	J5	20.0 N·m	J6	16.0 N·m
End Flange	solid	Custom Gantry Mount	✓	Main Purpose	handling/palletizing/load and unload/painting	
change to 5 axis	✓	Isolation Transformer	✓			

INSTALLATION DIMENSIONS

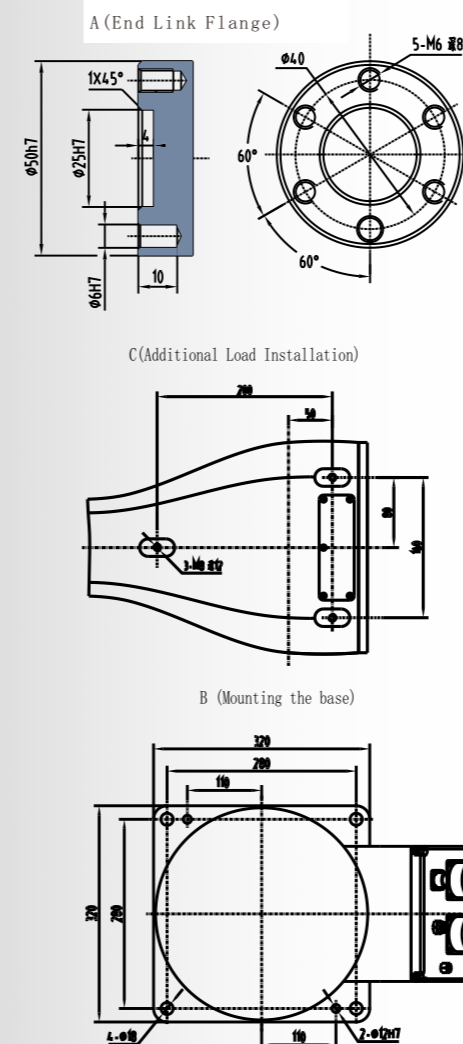

ACTUATION RANGE

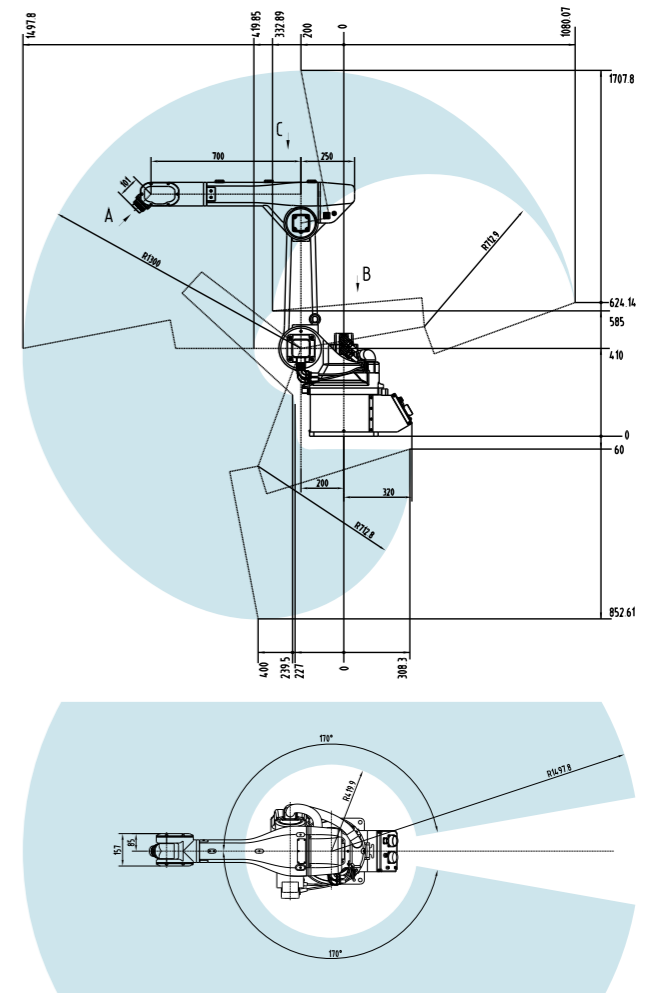

GD2010A HANDLING ROBOT



10KG Load **2000mm** Arm Span

TECHNICAL PARAMETERS

Basic Parameters	Degrees of Freedom	6		Installation Method	ground/side wall	
	Specified Load	10kg		Battery Capacity	2.5 KW	
	J3 Additional Load	12kg		Voltage	380V	
	Body Mass	230kg		Brake	all with brake	
	Repeatability	± 0.05mm				
Range of Motion	Maximum Reach at P	2000mm		J3	-85° ~+90°	
	Minimum Reach at P	457 mm		J4	± 360°	
	J1	± 170°		J5	± 120°	
	J2	-160° ~+80°		J6	± 360°	
Maximum Speed	J1	104° /s		J4	270° /s	
	J2	74° /s		J5	337° /s	
	J3	223° /s		J6	540° /s	
	Speed	1.5m/s				
allowable moment	J4	15.0 N·m	J5	15.0 N·m	J6	5.0 N·m
End Flange	solid	Custom Gantry Mount	✓	Main Purpose	handling/palletizing/load and unload/painting	
change to 5 axis	✓	Isolation Transformer	✓			

INSTALLATION DIMENSIONS

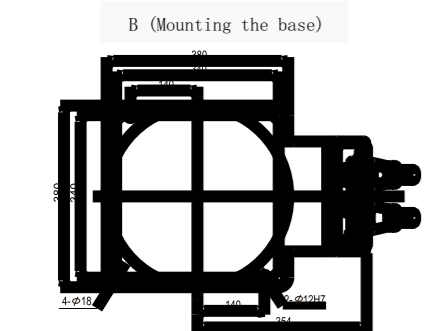
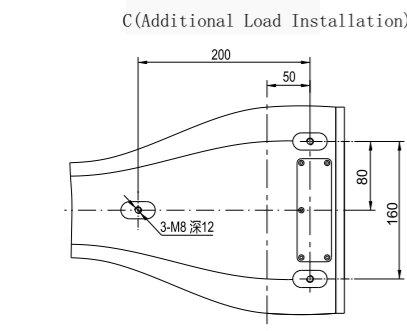
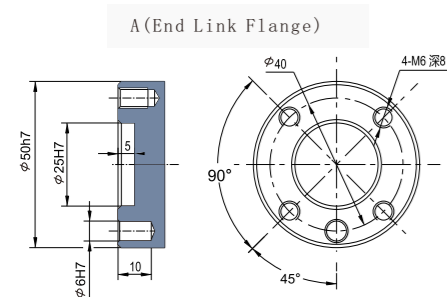

ACTUATION RANGE

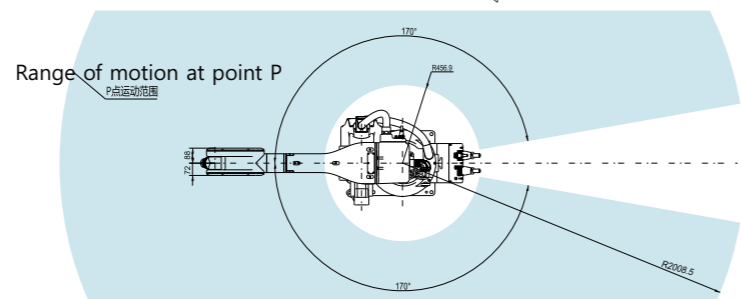
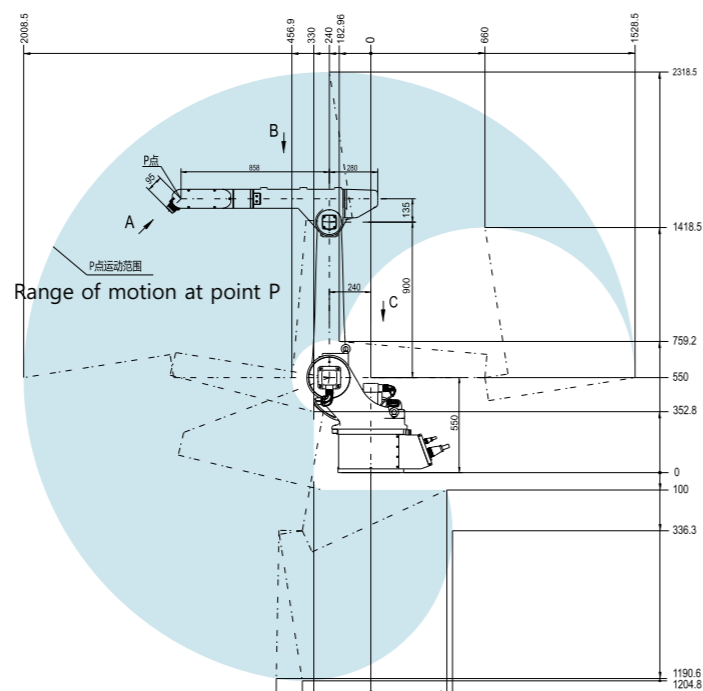

GD40814 HANDLING ROBOT



8KG Load **1400mm** Arm Span

TECHNICAL PARAMETERS

Basic Parameters	Degrees of Freedom	4		Installation Method	ground
	Specified Load	8kg		Battery Capacity	2.5 KW
	Humidity	0~50°C			
	Working Environment Temperature	20%~80%RH(no condensation)			
	Repeatability	± 0.08mm			
Range of Motion	J1	± 170°		J3	-9 0° ~+1 0°
	J2	-3 8° ~+7 8°		J4	± 360°
Maximum Speed	J1	15 0° /s		J3	2 2 5° /s
	J2	1 4 9° /s		J4	3 7 5° /s
Protection Grade	body IP53,wrist Ip54				
				Main Purpose	handling/palletizing/load and unload/

INSTALLATION DIMENSIONS

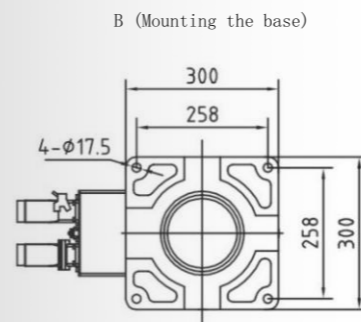
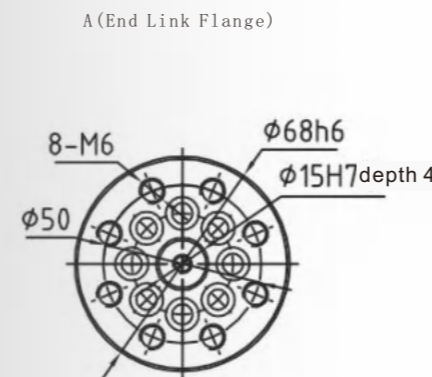

ACTUATION RANGE

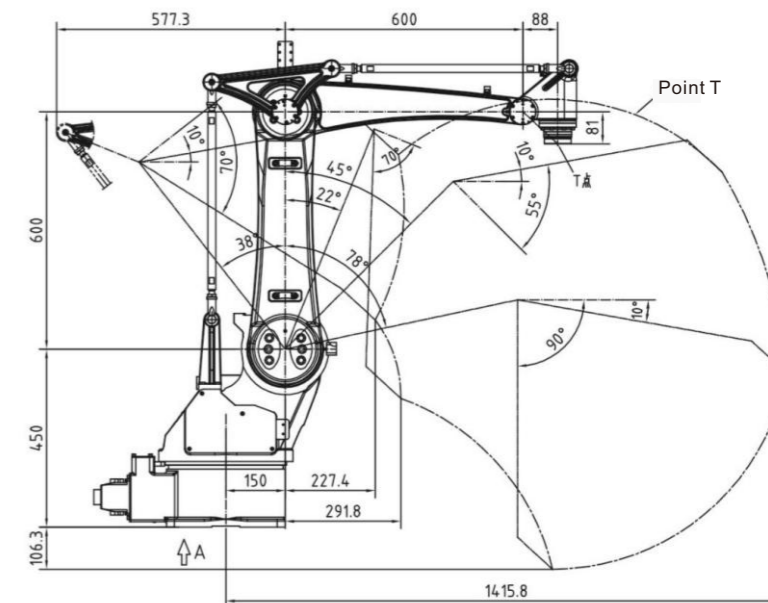

GD 42017 HANDLING ROBOT

20KG
Load

1770mm
Arm Span



TECHNICAL PARAMETERS

Basic Parameters	Degrees of Freedom	4	Installation Method	ground
	Specified Load	20kg	Battery Capacity	3.8 KW
	Humidity	20%~80%RH(no condensation)		
	Working Environment Temperature	0~50°C		
	Repeatability	± 0.08mm		
Range of Motion	J1	± 170°	J3	-90° ~+20°
	J2	-40° ~+85°	J4	± 360°
Maximum Speed	J1	150° /s	J3	150° /s
	J2	149° /s	J4	297.5° /s
Protection Grade	body IP53,wrist Ip54			
			Main urpose	handling/ palletizing/ load and unload/

INSTALLATION DIMENSIONS

A(End Link Flange)

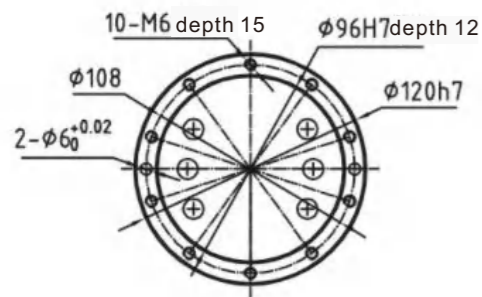

B (Mounting the base)

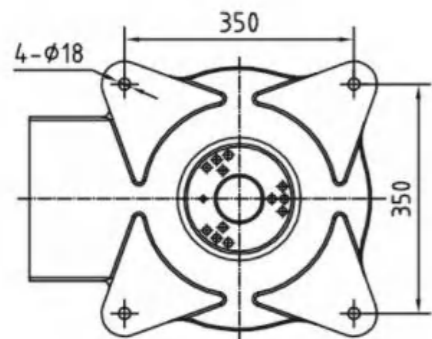

ACTUATION RANGE

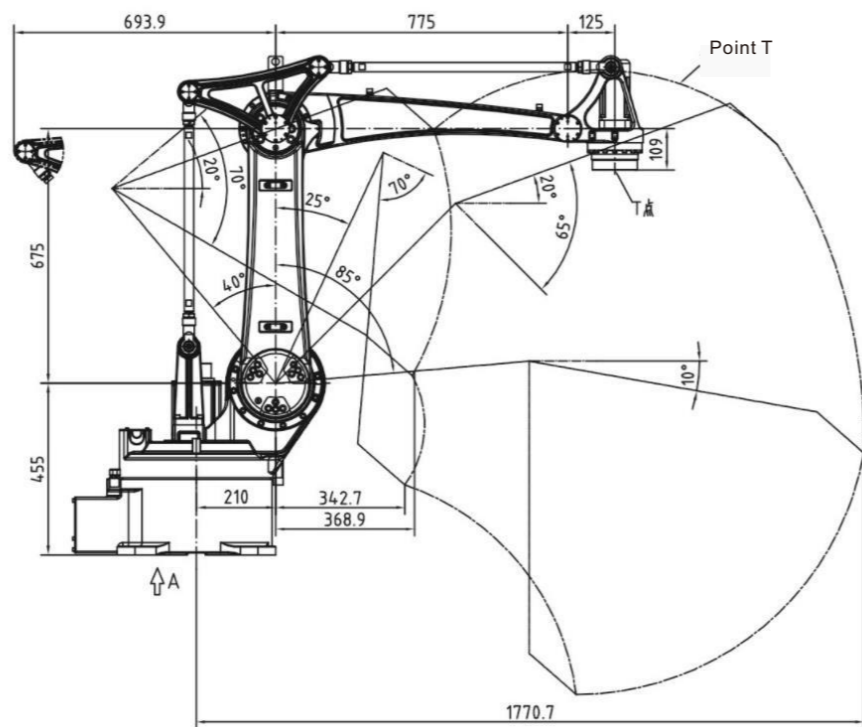

GD 2560A HANDLING ROBOT

60KG
Load

2499mm
Arm Span



TECHNICAL PARAMETERS

Basic Parameters	Degrees of Freedom	6	Installation Method	ground/side wall		
	Specified Load	60kg	Battery Capacity	9.0KW		
	J3 Additional Load	30kg	Voltage	380V		
	Body Mass	560kg	Brake	all with brake		
	Repeatability	± 0.15mm				
Range of Motion	Maximum Reach at P	2499mm	J3	-85° ~+145°		
	Minimum Reach at P	710mm	J4	± 360°		
	J1	± 170°	J5	± 125°		
	J2	-165° ~+90°	J6	± 360°		
Maximum Speed	J1	83° /s	J4	212° /s		
	J2	83° /s	J5	173° /s		
	J3	104° /s	J6	259° /s		
	Speed	1.0m/s				
allowable moment	J4	366.0 N · m	J5	307.0 N · m	J6	167.0 N · m
End Flange	solid	Custom Gantry Mount	×	Main Purpose	handling/palletizing/ load and unload/	
change to 5 axis	√	Isolation Transformer	×			

INSTALLATION DIMENSIONS

A(End Link Flange)

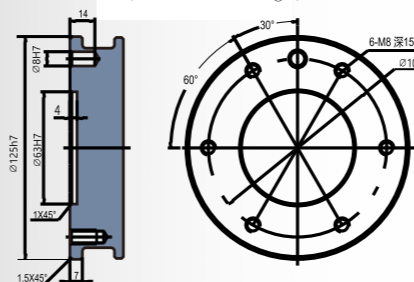

C(Additional Load Installation)

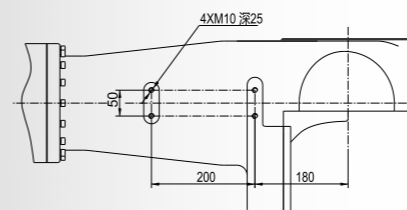

B (Mounting the base)

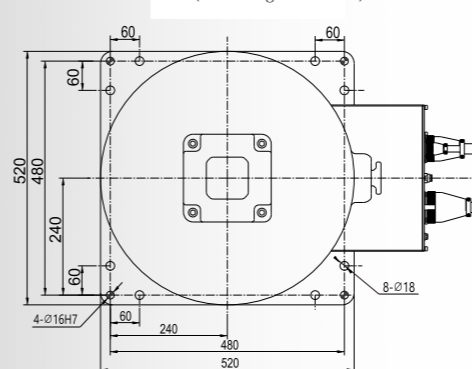

ACTUATION RANGE

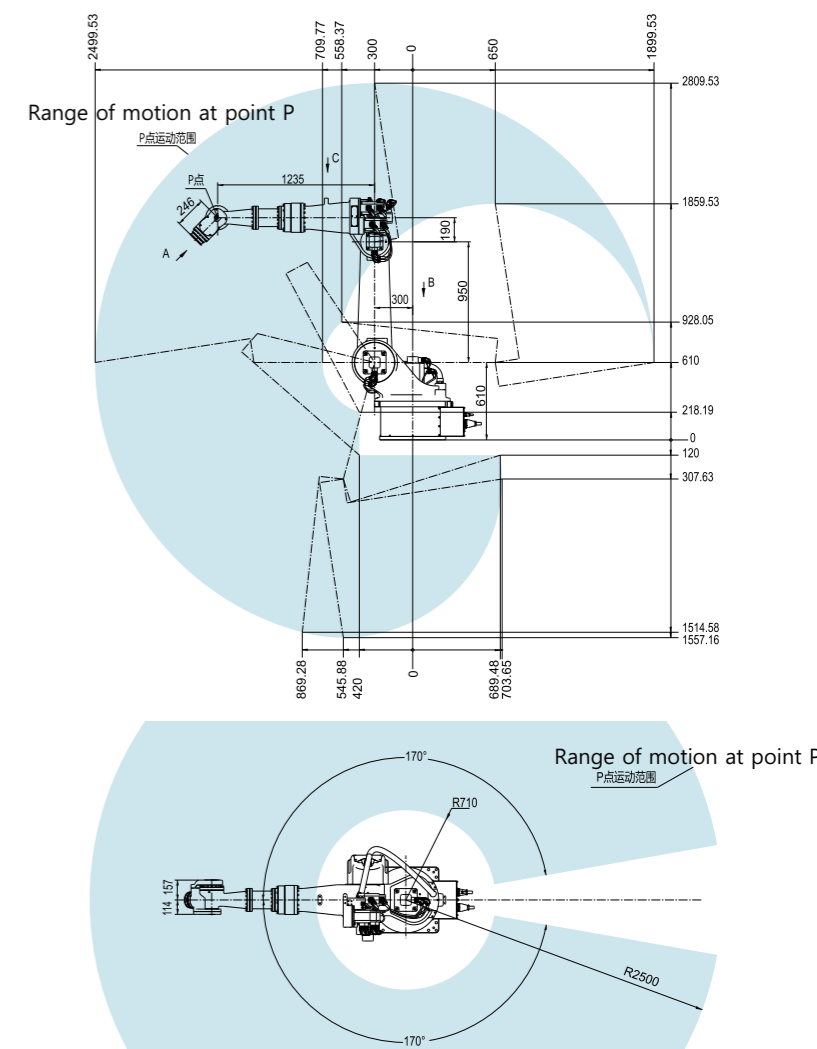

GD2380A HANDLING ROBOT



80KG Load **2302mm** Arm Span

TECHNICAL PARAMETERS				
Basic Parameters	Degrees of Freedom	6	Installation Method	ground/side wall
	Specified Load	80kg	Battery Capacity	9.0KW
	J3 Additional Load	30kg	Voltage	380V
	Body Mass	550kg	Brake	all with brake
	Repeatability	± 0.15mm		
Range of Motion	Maximum Reach at P	2302mm	J3	-84° ~+145°
	Minimum Reach at P	603mm	J4	± 360°
	J1	± 170°	J5	± 125°
	J2	-165° ~+90°	J6	± 360°
Maximum Speed	J1	83° /s	J4	212° /s
	J2	83° /s	J5	173° /s
	J3	104° /s	J6	259° /s
	Speed	1.0m/s		
allowable moment	J4	366.0 N·m	J5	307.0 N·m
End Flange	solid	Custom Gantry Mount	×	Main Purpose handling/palletizing/load and unload/ change to 5 axis ✓ Isolation Transformer ×

INSTALLATION DIMENSIONS

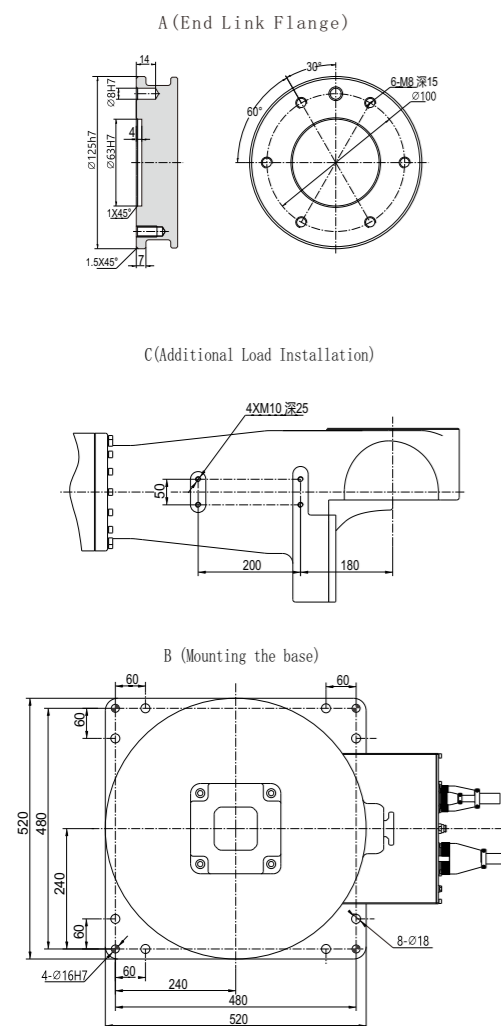

ACTUATION RANGE

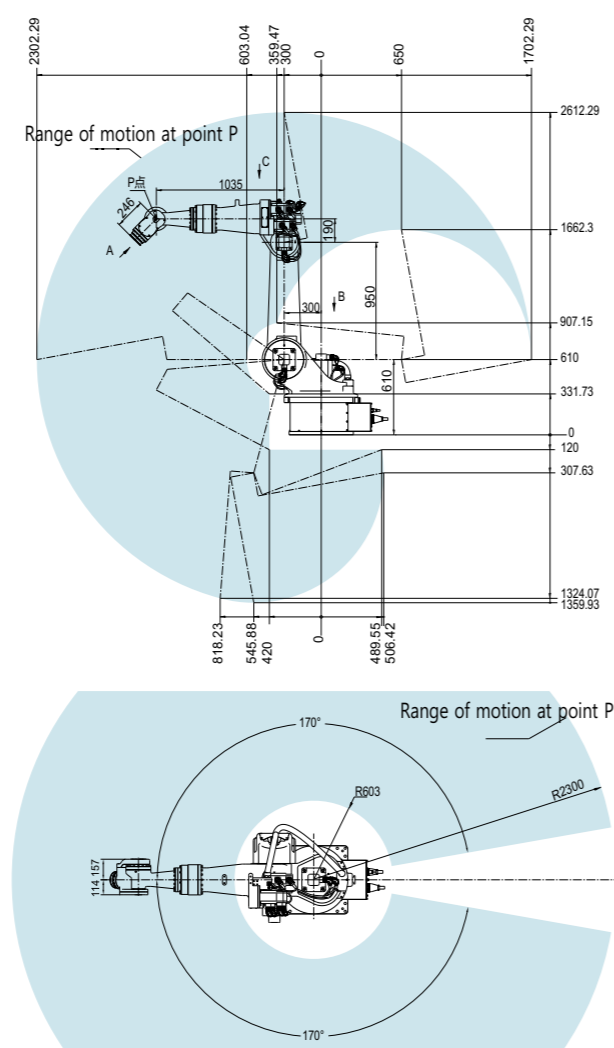

GD27180A HANDLING ROBOT

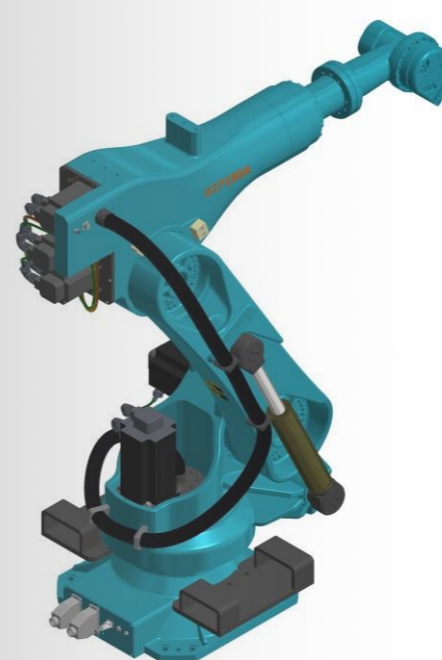

180KG Load **2720mm** Arm Span

TECHNICAL PARAMETERS				
Basic Parameters	Degrees of Freedom	6	Installation Method	ground
	Specified Load	180kg	Battery Capacity	14.0KW
	J3 Additional Load	30kg	Voltage	380V
	Body Mass	1035kg	Brake	all with brake
	Repeatability	± 0.15mm		
Range of Motion	Maximum Reach at P	2720mm	J3	-80° ~+110°
	Minimum Reach at P	738mm	J4	± 360°
	J1	± 180°	J5	± 120°
	J2	-93° ~+60°	J6	± 360°
Maximum Speed	J1	60° /s	J4	136° /s
	J2	63° /s	J5	148° /s
	J3	63° /s	J6	200° /s
	Speed	1.0m/s		
allowable moment	J4	980.0 N·m	J5	784.0 N·m
End Flange	solid	Custom Gantry Mount	×	Main Purpose handling/palletizing/load and unload/spot welding change to 5 axis ✓ Isolation Transformer ×

INSTALLATION DIMENSIONS

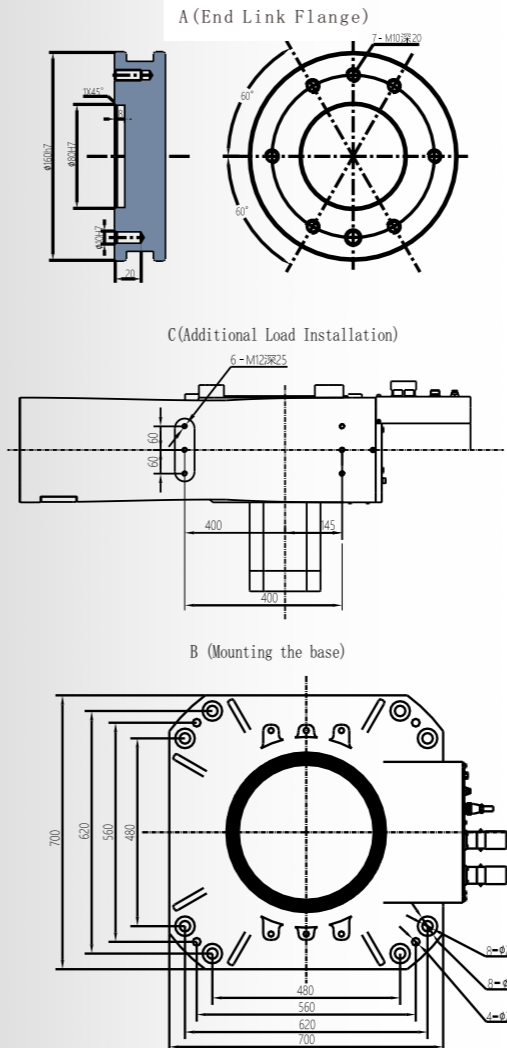

ACTUATION RANGE

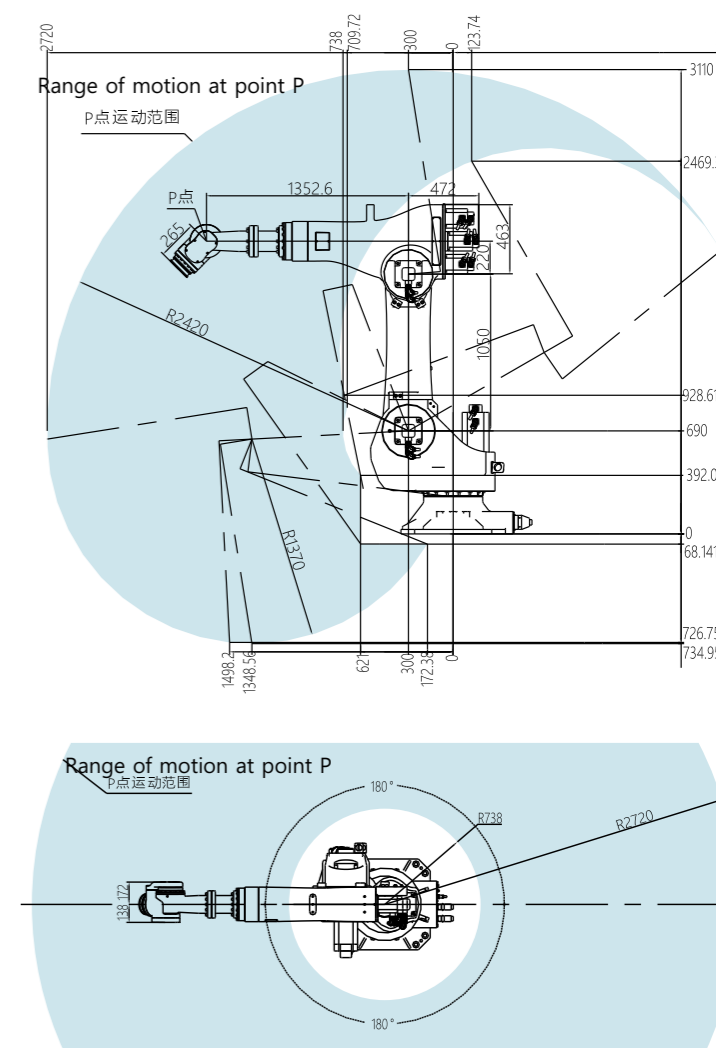

GD25210A HANDLING ROBOT



210KG Load **2523mm** Arm Span

TECHNICAL PARAMETERS

Basic Parameters	Degrees of Freedom	6		Installation Method	ground	
	Specified Load	210kg		Battery Capacity	14.0KW	
	J3 Additional Load	30kg		Voltage	380V	
	Body Mass	1025kg		Brake	all with brake	
	Repeatability	± 0.15mm				
Range of Motion	Maximum Reach at P	2523mm		J3	-80° ~ +110°	
	Minimum Reach at P	549 mm		J4	± 360°	
	J1	± 180°		J5	± 120°	
	J2	-93° ~ +60°		J6	± 360°	
Maximum Speed	J1	60° /s		J4	136° /s	
	J2	63° /s		J5	148° /s	
	J3	63° /s		J6	200° /s	
	Speed	1.0m/s				
allowable moment	J4	980.0 N·m	J5	784.0 N·m	J6	412.0 N·m
End Flange	solid	Custom Gantry Mount	×	Main Purpose	handling/palletizing/ load and unload/ spot welding	
change to 5 axis	✓	Isolation Transformer	×			

INSTALLATION DIMENSIONS

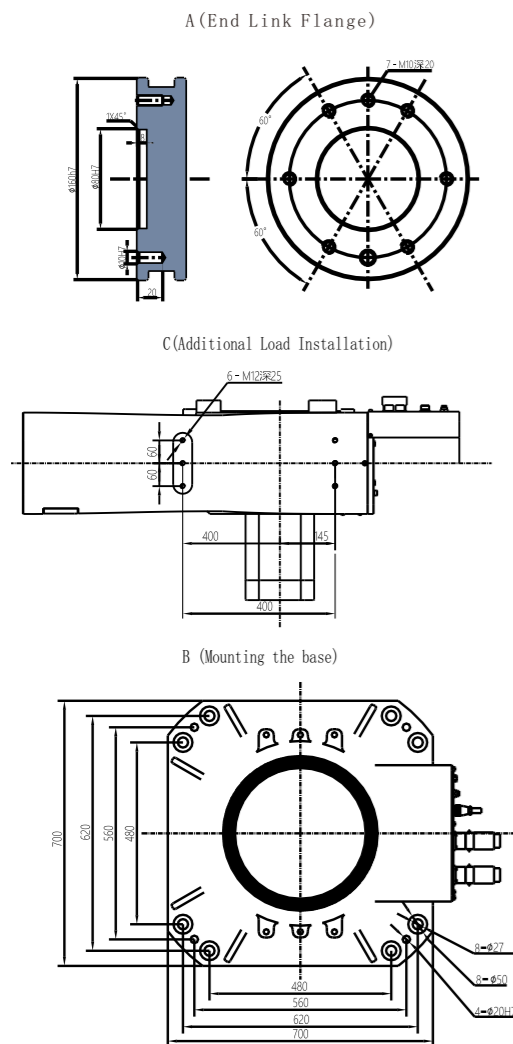

ACTUATION RANGE

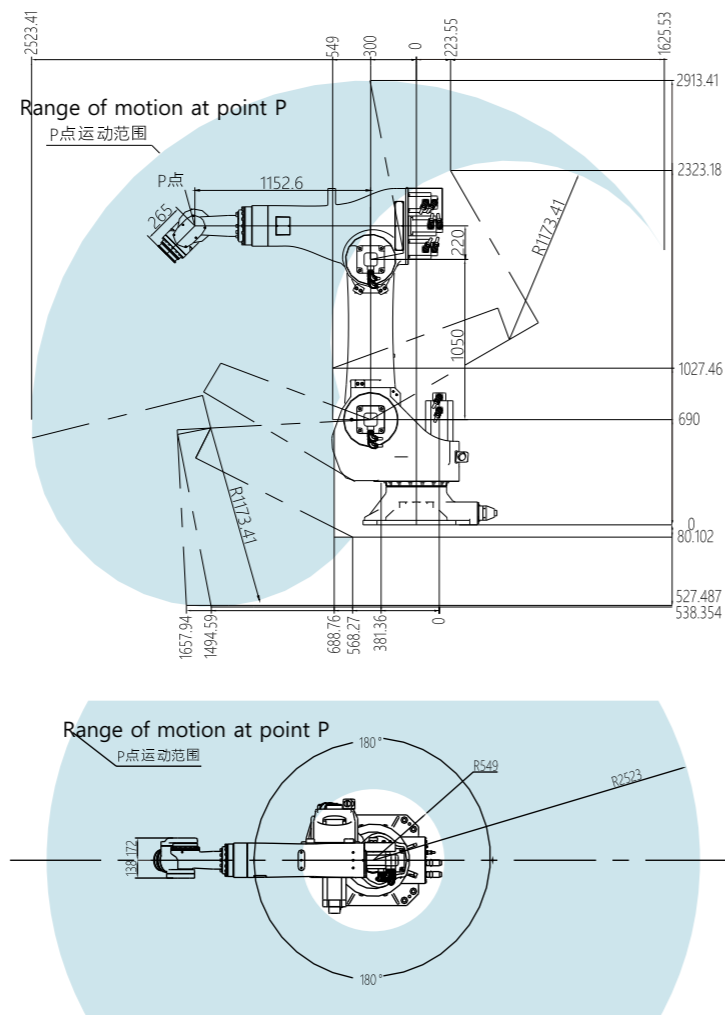

1.5m/1.8m/2.0m Load
welding 6 axis robot
Built-in torch structure

NEW SERIES WELDING ROBOT

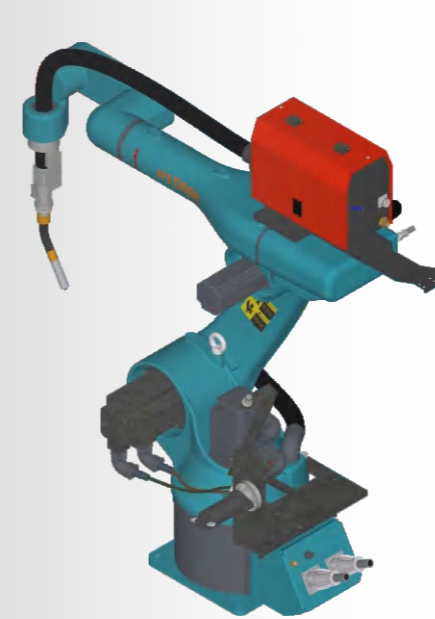

GD1506B
Arm Span 1.5m

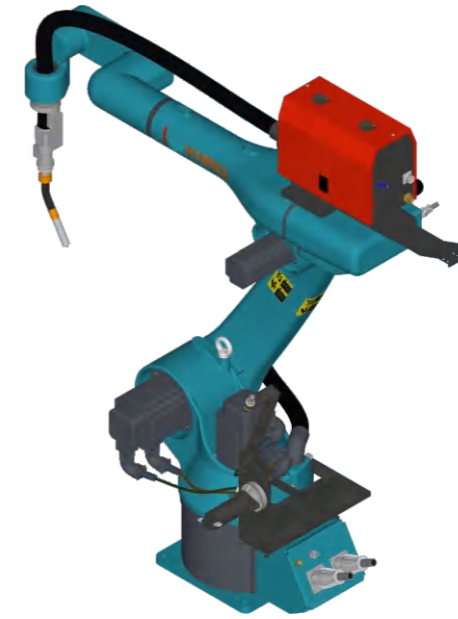

GD1806B
Arm Span 1.8m

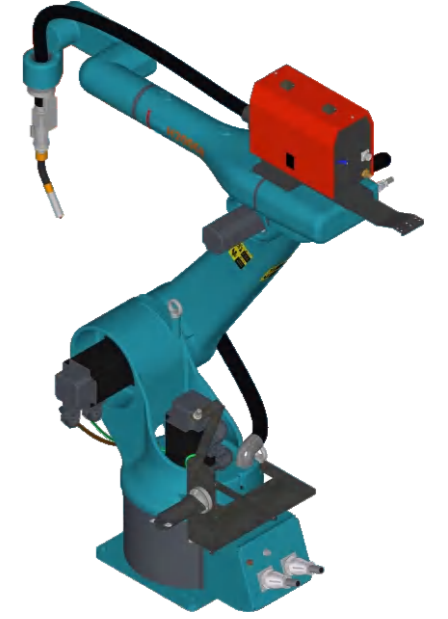

GD2006B
Arm Span 2.0m



GD1506B
Arm Span 1.5m



GD 2006B
Arm Span 2.0m

NEW SERIES WELDING ROBOT



Technical Parameter

	GD1506B	GD1806B	GD2006B	
Basic Parameters	Degrees of Freedom	6	6	6
	Specified Load	6 Kg	6 Kg	6 Kg
	J3Additional Load	12 Kg	12 Kg	12 Kg
	Repeatability	± 0.05mm	± 0.05mm	± 0.05mm
	Body Mass	164Kg	162Kg	约232Kg
	Installation Method	ground/side wall	ground/side wall	ground/side wall
	Battery Capacity	2.5 KW	2.5 KW	2.5 KW
	Voltage	380V	380V	380V
	Brake	J2、3、4、5 with brake	J2、3、4、5 with brake	J2、3、4、5with brake
	Range of Motion	Maximum Reach at P	1551 mm	1797 mm
Minimum Reach at P		455 mm	437 mm	457 mm
J1		± 170°	± 170°	± 170°
J2		-160° ~ +80°	-160° ~ +80°	-160° ~ +80°
J3		-85° ~ +90°	-85° ~ +90°	-85° ~ +90°
J4		± 360°	± 360°	± 360°
J5		± 360°	± 360°	± 360°
Maximum Speed	J1	138° /s	138° /s	104° /s
	J2	138° /s	138° /s	74° /s
	J3	223° /s	223° /s	223° /s
	J4	270° /s	270° /s	270° /s
	J5	337° /s	337° /s	337° /s
	J6	1070° /s	1070° /s	1070° /s
	Speed	1.5 m/s	1.5 m/s	1.5 m/s
Allowable Moment	J4	15.0 N·m	15.0 N·m	15.0 N·m
	J5	15.0 N·m	15.0 N·m	15.0 N·m
	J6	4.3 N·m	4.3 N·m	4.3 N·m
Other	End Flange	hollow	hollow	hollow
	Suitable for Welding Gun	built-in	built-in	built-in
	Welding Gun Line Length	1.2 m	1.35 m	1.35 m
	Change to 5 Axis	✓	✓	✓
	Custom Upside Down Switch	✓	✓	✓
	Isolation Transformer	✓	✓	✓
Main Purpose	welding	welding	welding	

GD1506B WELDING ROBOT

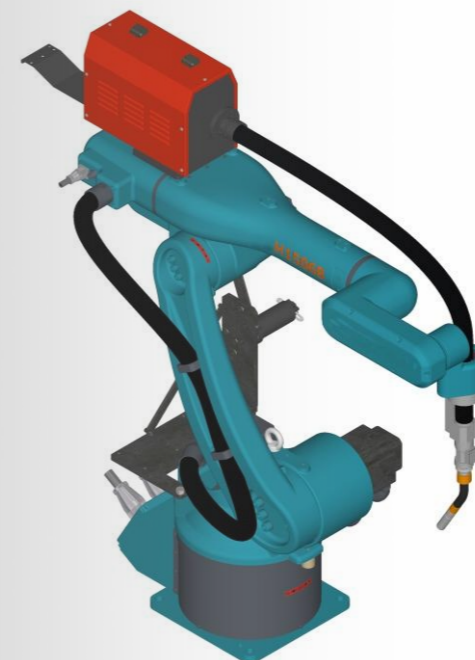

6KG Load

1500mm Arm Span

TECHNICAL PARAMETERS

Basic Parameters	Degrees of Freedom	6	Installation Method	ground/side wall		
	Specified Load	6kg	Battery Capacity	2.5KW		
	J3 Additional Load	12kg	Voltage	380V		
	Body Mass	164kg	Brake	J2、3、4、5with brake		
	Repeatability	± 0.05mm				
Range of Motion	Maximum Reach at P	1551 mm	J3	-85° ~+90°		
	Minimum Reach at P	455 mm	J4	± 360°		
	J1	± 170°	J5	± 360°		
	J2	-160° ~+80°	J6	± 360°		
Maximum Speed	J1	138° /s	J4	270° /s		
	J2	138° /s	J5	337° /s		
	J3	223° /s	J6	1070° /s		
	Speed	1.5m/s	Main Purpose	welding		
allowable moment	J4	15.0 N·m	J5	15.0 N·m	J6	4.3 N·m
End Flange	hollow	Custom Gantry Mount	✓	Suitable for welding gun	built-in	
change to 5 axis	✓	Isolation Transformer	✓	Welding gun line length	1.2m	

INSTALLATION DIMENSIONS

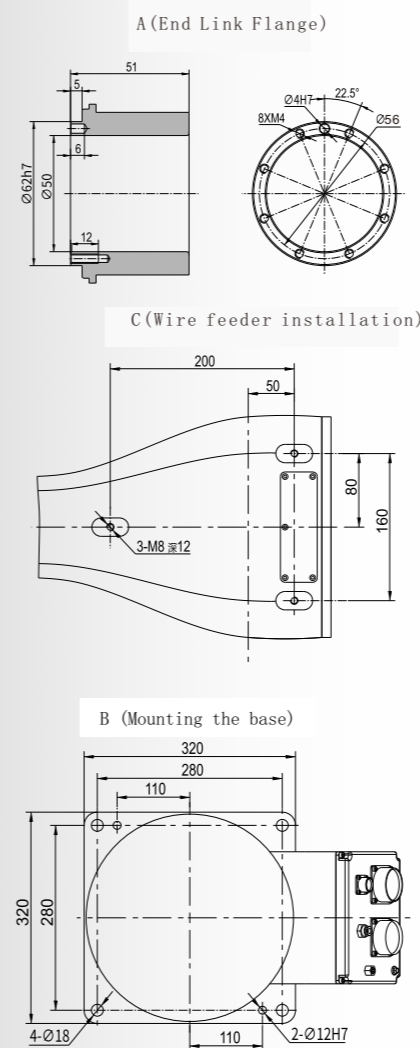

ACTUATION RANGE

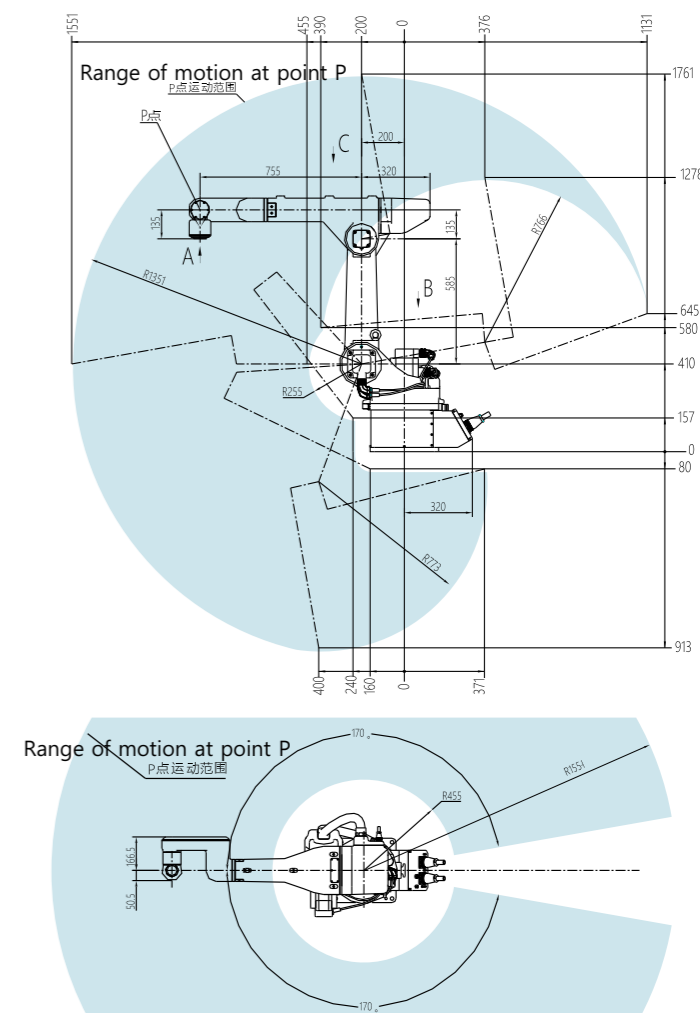

GD1806B WELDING ROBOT

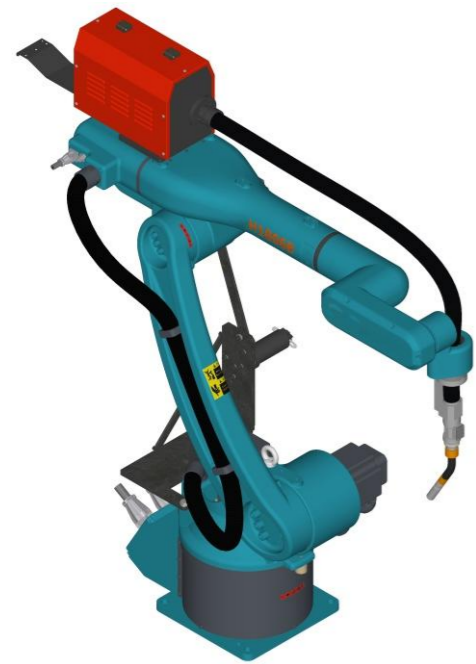

6KG
Load

1800mm
Arm Span

TECHNICAL PARAMETERS

Basic Parameters	Degrees of Freedom	6	Installation Method	ground/side wall		
	Specified Load	6kg	Battery Capacity	2.5KW		
	J3 Additional Load	12kg	Voltage	380V		
	Body Mass	162kg	Brake	JJ2、3、4、5with brake		
	Repeatability	±0.05mm				
Range of Motion	Maximum Reach at P	1797 mm	J3	-85° ~+90°		
	Minimum Reach at P	437 mm	J4	±360°		
	J1	±170°	J5	±360°		
	J2	-160° ~+80°	J6	±360°		
Maximum Speed	J1	138° /s	J4	270° /s		
	J2	138° /s	J5	337° /s		
	J3	223° /s	J6	1070° /s		
	Speed	1.5m/s	Main Purpose	welding		
allowable moment	J4	15.0 N·m	J5	15.0 N·m	J6	4.3 N·m
End Flange	hollow	Custom Gantry Mount	✓ Suitable for welding gun	built-in		
change to 5 axis	✓	Isolation Transformer	✓	Welding gun line length	1.35m	

INSTALLATION DIMENSIONS

A (End Link Flange)

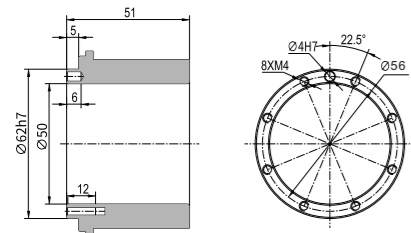

C (Wire feeder installation)

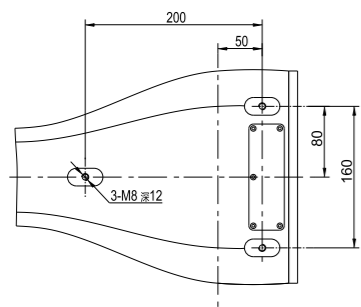

B (Mounting the base)

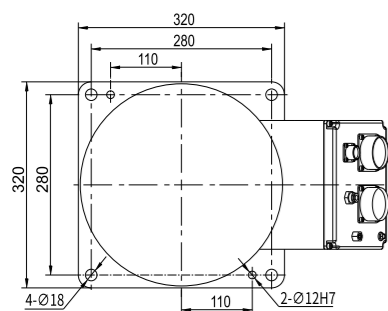

ACTUATION RANGE

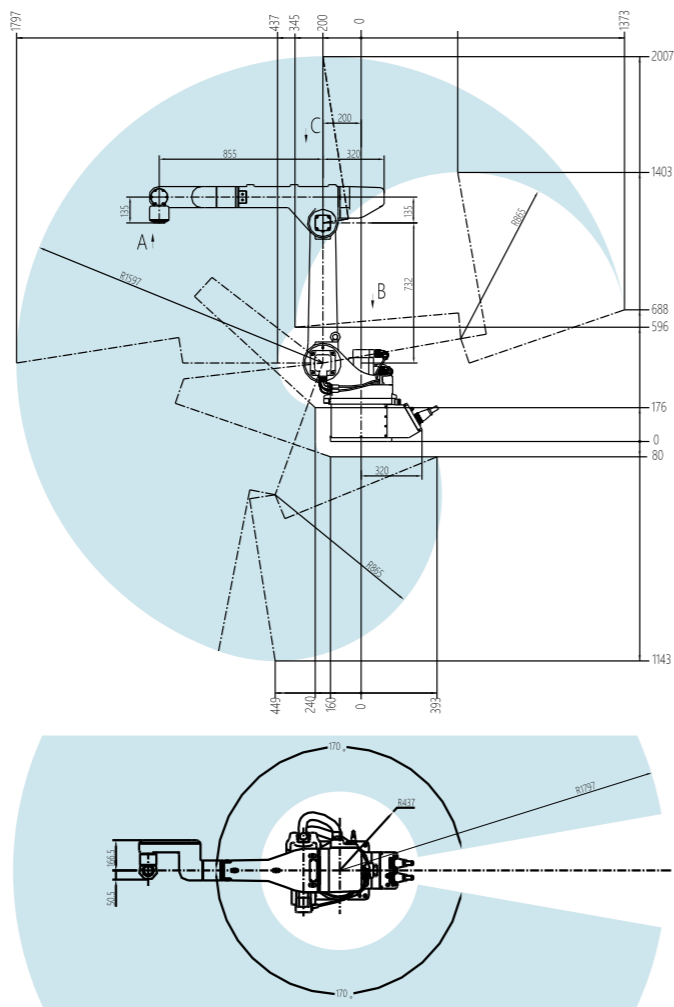

GD2006B WELDING ROBOT

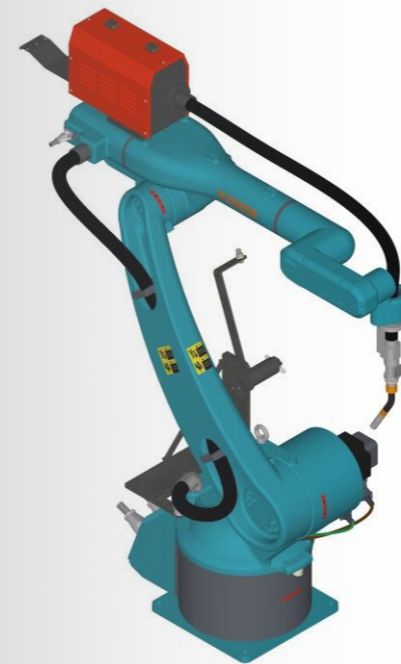

6KG
Load

2000mm
Arm Span

TECHNICAL PARAMETERS

Basic Parameters	Degrees of Freedom	6	Installation Method	ground/side wall		
	Specified Load	6kg	Battery Capacity	2.5KW		
	J3 Additional Load	12kg	Voltage	380V		
	Body Mass	232kg	Brake	J2、3、4、5with brake		
	Repeatability	±0.05mm				
Range of Motion	Maximum Reach at P	2005mm	J3	-85° ~+90°		
	Minimum Reach at P	457 mm	J4	±360°		
	J1)	±170°	J5	±360°		
	J2	-160° ~+80°	J6	±360°		
Maximum Speed	J1	104° /s	J4	270° /s		
	J2	74° /s	J5	337° /s		
	J3	223° /s	J6	1070° /s		
	Speed	1.5m/s	Main Purpose	welding		
allowable moment	J4	15.0 N·m	J5	15.0 N·m	J6	4.3 N·m
End Flange	hollow	Custom Gantry Mount	✓ Suitable for welding gun	built-in		
change to 5 axis	✓	Isolation Transformer	✓	Welding gun line length	1.35m	

INSTALLATION DIMENSIONS

A (End Link Flange)

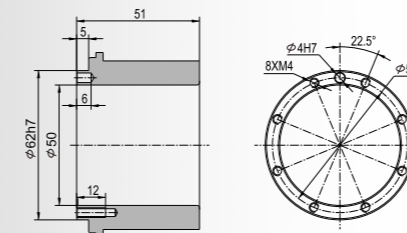

C (Wire feeder installation)

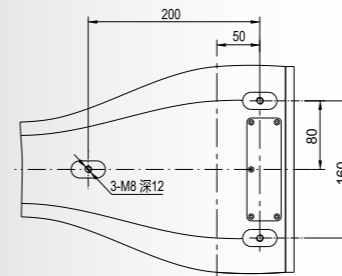

B (Mounting the base)

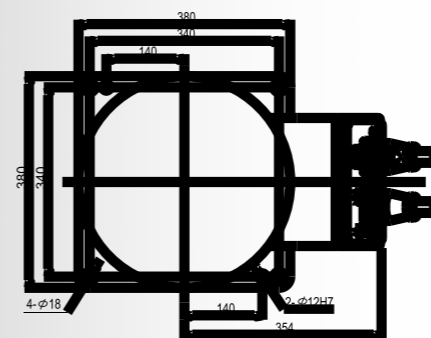

ACTUATION RANGE

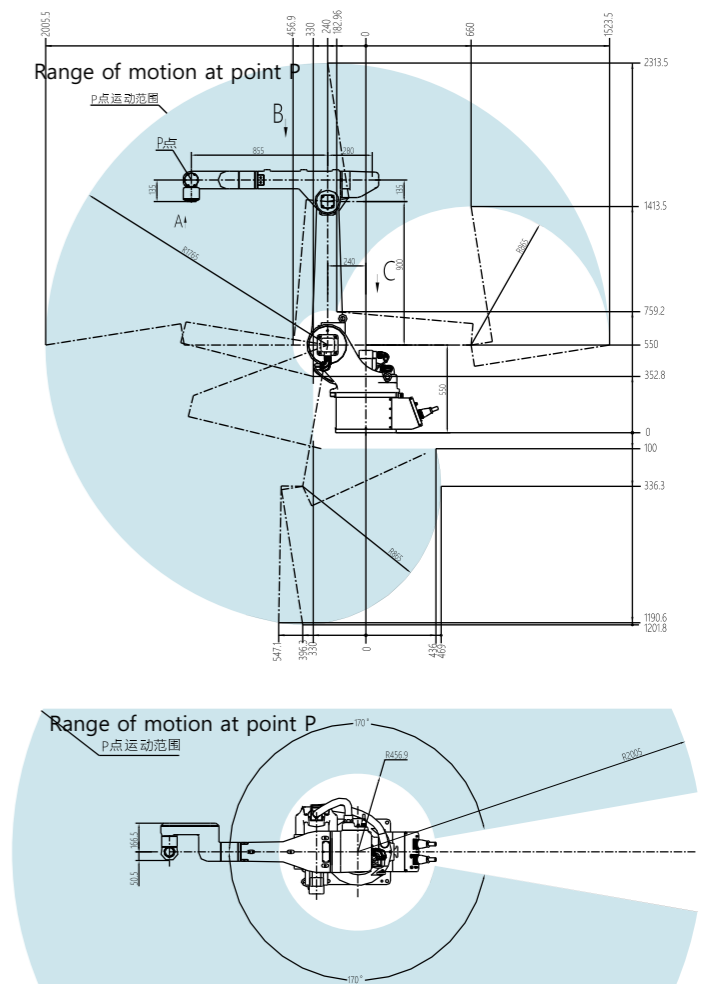

GD-PT-200/500

Platform type double axis servo positioner

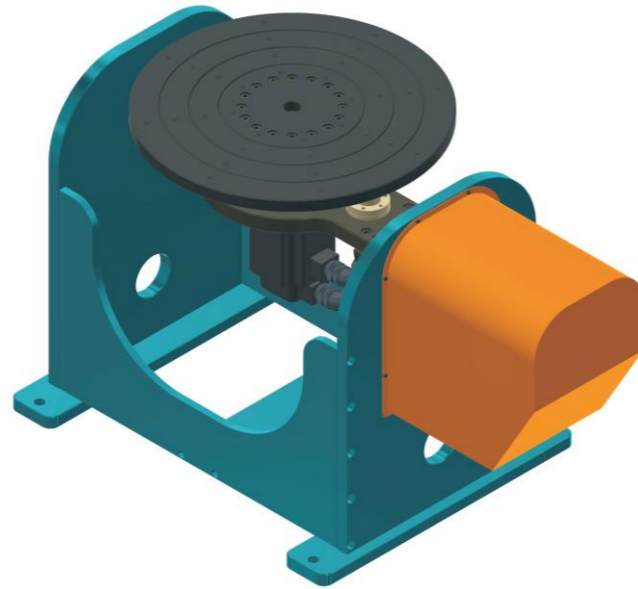

PRODUCT INTRODUCTION

- The dual-axis servo positioner is mainly composed of a welded integral frame, a rotary platform, an AC servo motor, an RV precision reducer, a rotary support, a conductive mechanism, a protective shield and an electrical control system.
- The whole frame is welded with high-quality profiles. After annealing and stress relief, it is processed by professional machining, which can ensure the high precision of processing and use of key positions. The surface is sprayed with anti-rust appearance paint, which is beautiful and elegant, and the color can be customized according to customer requirements. Customize.
- The rotary platform is made of high-quality section steel and processed by professional machining, and the surface is machined with standard threaded holes for installation and positioning tooling, and blackened and rust-proof.
- Selecting AC servo motor and RV reducer as the power mechanism can ensure the stability of rotation, the accuracy of positioning, long service life and low failure rate.
- The conductive mechanism adopts brass as the conductive mechanism, which can play a good conductive effect. The conductive base adopts the overall insulation, which can effectively protect the servo motor, robot and welding power source.
- The electrical control system adopts Japan's Mitsubishi PLC to control the positioner, with stable performance and low failure rate.

TECHNICAL PARAMETERS

	GD-PT-200	GD-PT-200K	GD-PT-500
specified load	200kg	200kg	500kg
Standard radius of gyration	R400	R400	R400
The first axis flip angle	±90°	±90°	±90°
Second axis rotation angle	±360°	±360°	±360°
Rated turning speed of the first axis	123° /S	123° /S	56° /S
Rated rotation speed of the second axis	99° /S	137° /S	93° /S
Repeatability	±0.05°C	±0.05°C	±0.05°C
Dimensions of the positioner	1080×600×660mm	1080×600×660mm	1130×600×706mm
Standard two-axis rotary table	φ550mm	φ550mm	φ550mm
Through hole size	/	φ48mm	/
The height of the center of rotation of one axis	510mm	510mm	550mm
Power supply conditions	200V ±10% 50Hz	200V ±10% 50Hz	200V ±10% 50Hz
Insulation class	H	H	H
Equipment net weight	300kg	300kg	330kg

Remark: The radius of the second shaft axis is within the range of R300mm

GD-ZW

Main tail box type single axis servo Positioner

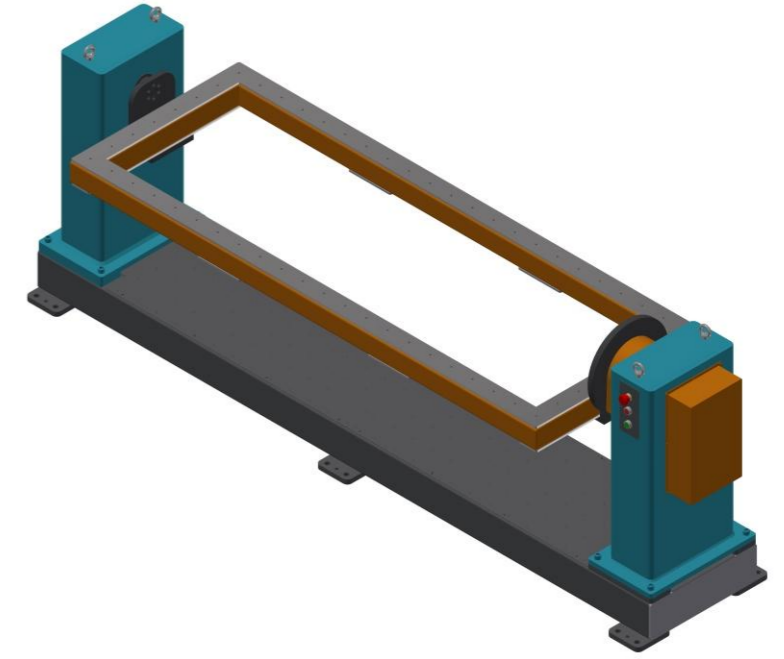

PRODUCT INTRODUCTION

- The single-axis servo positioner is mainly composed of an integral fixed base, a rotating headstock and a tail box, a welded positioner, an AC servo motor, an RV precision reducer, a conductive mechanism and a protective cover.
- The fixed base is welded with high-quality profiles. After annealing to relieve stress, it is processed by professional machining, which can ensure the high precision of processing and use of key positions. The surface is sprayed with anti-rust appearance paint, which is beautiful and elegant, and the color can be customized according to customer requirements. .
- The rotary headstock and tail box are made of high-quality section steel after welding, annealing and professional machining, which can ensure their long-term durability and stability.
- The welding displacement frame is welded with high-quality profiles. After annealing, professional machining is performed to ensure the smoothness of the use surface and its own stability. The upper surface is processed with threaded holes with standard spacing, which is convenient for customers to install and fix Positioning tooling.
- Selecting AC servo motor and RV reducer as the power mechanism can ensure the stability of rotation, the accuracy of positioning, long service life and low failure rate.

TECHNICAL PARAMETERS

	GD-ZW-416	GD-ZW-422	GD-ZW-425
specified load	400kg	400kg	400kg
Standard radius of gyration	R600mm	R600mm	R600mm
Maximum flip angle	±360°	±360°	±360°
Rated flip speed	99° /S	99° /S	99° /S
Repeatability	±0.05°C	±0.05°C	±0.05°C
Dimensions of displacement frame	1600×800×80mm	2200×800×80mm	2500×800×80mm
Outline dimension of positioner	2350×620×1250mm	2950×620×1250mm	3250×620×1250mm
Spindle turntable	φ360mm	φ360mm	φ360mm
The height of the center of rotation of one axis	845mm	845mm	845mm
Insulation class	H	H	H
Equipment net weight	560kg	约600kg	640kg

Remark: The rated load is within the radius of the spindle axis R400mm

GD-ZZ-200/500

Single axis spindle box servo positioner

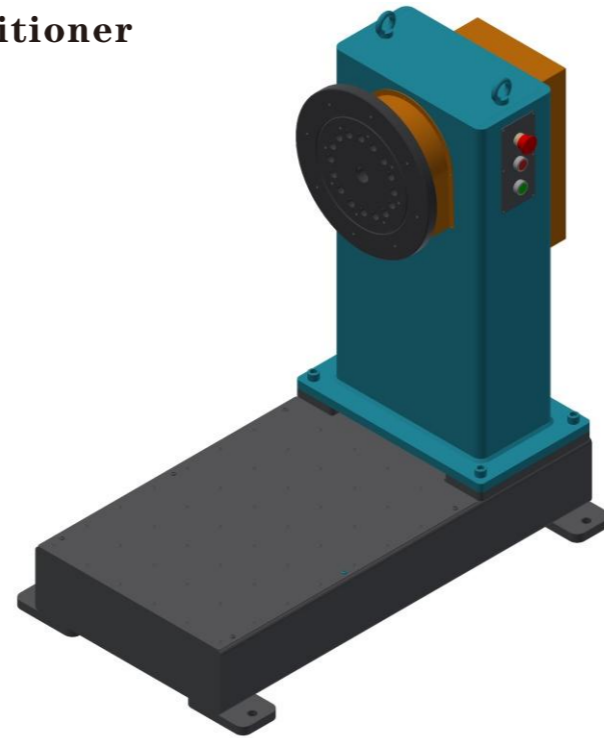

PRODUCT INTRODUCTION

- The single-axis servo positioner is mainly composed of an integral fixed base, a rotating headstock, an AC servo motor, an RV precision reducer, a conductive mechanism, a protective cover, and an electrical control system.
- The fixed base is welded with high-quality profiles. After annealing and stress relief, it is processed by professional machining to ensure the processing and use accuracy of key positions. The surface is sprayed with anti-rust appearance paint, which is beautiful and elegant, and the color can be customized according to customer requirements.
- The rotary headstock is made of high-quality section steel after welding, annealing and professional machining, which can ensure its long-term durability and stability.
- Selecting AC servo motor and RV reducer as the power mechanism can ensure the stability of rotation, the accuracy of positioning, long service life and low failure rate.
- The conductive mechanism adopts brass as the conductive mechanism, which can play a good conductive effect. The conductive base adopts the

TECHNICAL PARAMETERS

	GD-ZZ-200	GD-ZZ-200K	GD-ZZ-500
specified load	200kg	200kg	500kg
Standard radius of gyration	R600mm	R600mm	R600mm
Maximum swivel angle	± 360°	± 360°	± 360°
Rated rotation speed	99° /S	153° /S	56° /S
Repeatability	± 0.05°C	± 0.05°C	± 0.05°C
Outline dimension of positioner	1050 × 620 × 1050mm	1050 × 620 × 1050mm	1200 × 750 × 1200mm
Spindle turntable	φ 360mm	φ 400mm	φ 400mm
Working plate size	/	φ 40mm	/
The height of the center of rotation of one axis	850mm	850mm	900mm
Insulation class	H	H	H
Equipment net weight	200kg	200kg	260kg

Remark:It is within the radius of the spindle axis R300mm, and the center of gravity is less than or equal to 300mm from the flange.

GD-SP1-416

Single axis horizontal rotation servo Positioner

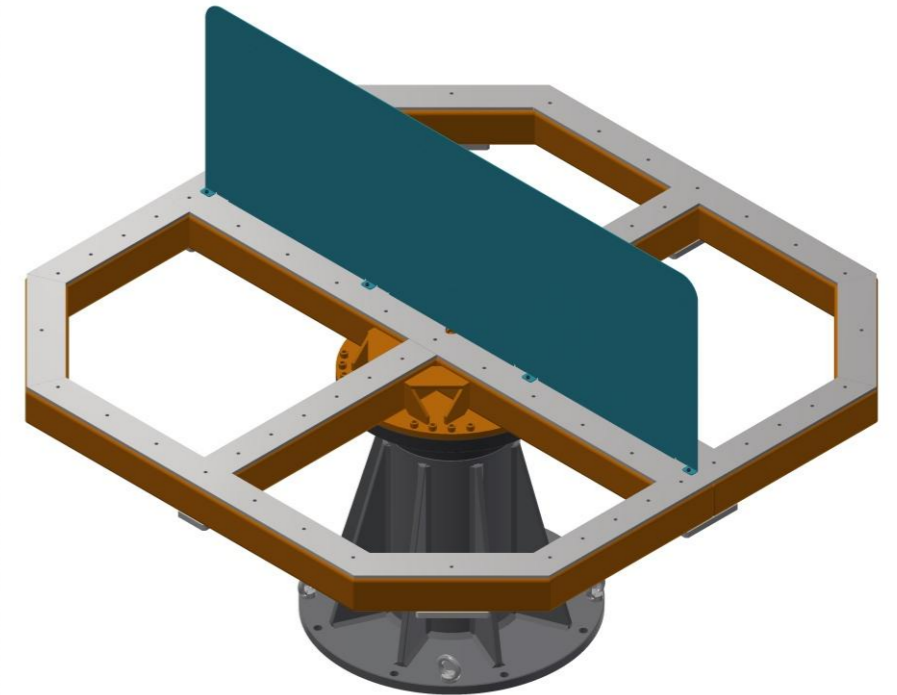

PRODUCT INTRODUCTION

- The single-axis horizontal rotary servo positioner is mainly composed of a welded integral frame, a rotary position frame, an AC servo motor, an RV precision reducer, a conductive mechanism, and an electrical control system.
- The whole frame is welded with high-quality profiles. After annealing and stress relief, it is processed by professional machining, which can ensure the high precision of processing and use of key positions. The surface is sprayed with anti-rust appearance paint, which is beautiful and elegant, and the color can be customized according to customer requirements. Customize.
- The rotary shift frame is made of high-quality section steel after being welded and formed by professional machining. The surface is machined with standard threaded holes for installation and positioning tooling, and is painted and rust-proofed.
- Selecting AC servo motor and RV reducer as the power mechanism can ensure the stability of rotation, the accuracy of positioning, long service life and low failure rate.
- The conductive mechanism adopts brass as the conductive mechanism, which can play a good conductive effect. The conductive base adopts the

TECHNICAL PARAMETERS

	GD-SP1-416
specified load	400KG (single frame200KG)
Spindle standard turning radius	R1200mm
Rotation angle	± 180°
Rated rotation speed	55° /S
Repeatability	± 0.05°C
Outline dimensions of displacement frame	(1600 × 800 × 80mm) × 2
Dimensions of the positioner	1600 × 1600 × 1250mm
Positioner working table height	750mm
Power supply conditions	200V ± 10% 50HZ
Insulation class	H
Equipment net weight	490kg

